

AFF A150 Systems Installation and Setup Instructions



Prepare and install | Stage 1



Pre-setup

1. Unpack all boxes and inventory contents.

Attention: Customers with specific power requirements must check [Hardware Universe](#) for their configuration options.

2. Gather information about your storage system by completing the cluster setup worksheets:
[Get started with ONTAP cluster set up.](#)

3. Review the requirements and procedure steps for [Configure ONTAP on a new cluster with System Manager.](#)

Note: For MetroCluster configurations, use the [MetroCluster installation content.](#)



Contents in the box

Cables shown are the most common. See [Hardware Universe](#) for more options.

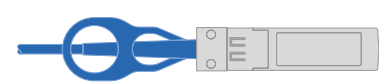

10 GbE network cable
(order dependent)
Cluster interconnect cable
Part numbers X6566B-2-R6;
X6566B-3-R6; X6566B-5-R6



CAT6 RJ-45 cable
(order dependent)
Part numbers X6585-R6;
X6562-R6

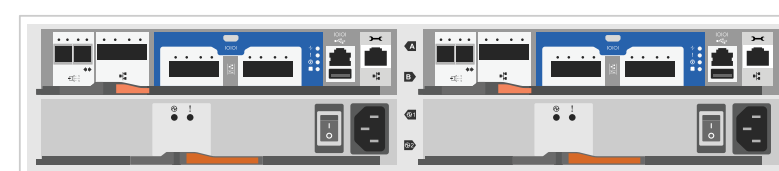

Unified configuration (order dependent)

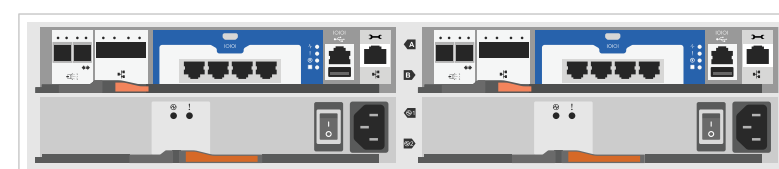

Ethernet configuration (order dependent)



Optical network cable
(order dependent)
Part numbers X6553-R6;
X6554-R6; X6536-R6



**mini-SAS HD to
mini-SAS HD cable**
Storage cables
Part numbers X66030A;
X66031A; X66032A; X66033A

Slide rail kit

Cable management arms

Additional cables

- Ethernet cables



- Power cables



- micro USB console cable



You provide



Rack space

2U for platform +2U
for each DS224C shelf



Screwdriver

Phillips #2



Additional network cables

For connecting your storage system
to your network switch and laptop
or console



Laptop or console

With a USB/serial connection
and access to a Web browser to
configure your storage system



Install storage system in a rack or cabinet

Attention: Airflow through the platform and shelves enters from the front where the bezel or end caps are installed and exhausts out the rear where the ports are located.

1. Install rail kits for the platform and shelves, as needed, using instructions included with the kits.
2. Install the platform chassis into the rack or cabinet.
3. Attach the cable management devices to the rear of the platform.
4. Install the bezel on the front of the platform.
5. Install any drive shelves into the rack or cabinet.

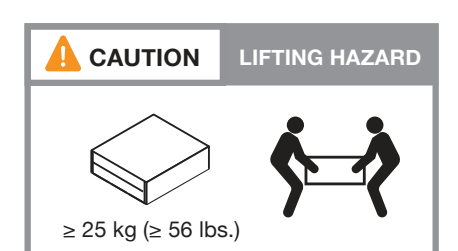
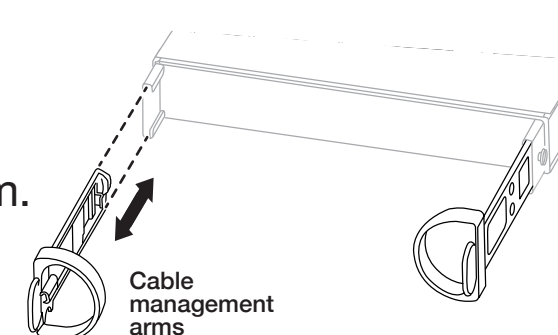

Cable controllers | Stage 2

Attention: Be sure to check the illustration arrow for the proper cable connector pull-tab orientation.
Note: To unplug a cable, gently pull the tab to release the locking mechanism.

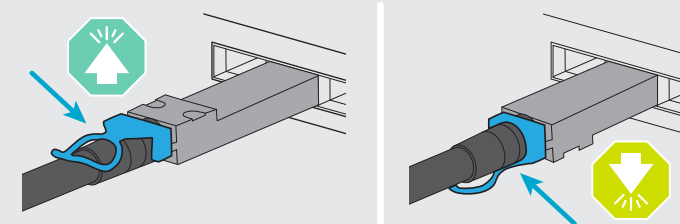

1 Cable the controllers for a switchless or switched cluster

See your network administrator for help connecting to your switches.



1 For switchless cluster

Cable port e0a to port e0a and port e0b to port e0b.

For switched cluster

Cable port e0a and port e0b on each controller to the cluster interconnect switches.

2 For Unified configuration



On each controller, connect ports e0c/0c and e0d/0d OR ports e0e/0e and e0f/0f to the FC host network switches.

For Ethernet configuration



On each controller, connect ports e0c and e0e OR ports e0d and e0f to the data network switches.

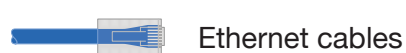

3 Connect the wrench port (e0M/BMC) to the management switches.

4 Strap the cables to the cable management arms. (not shown)

Switchless cluster

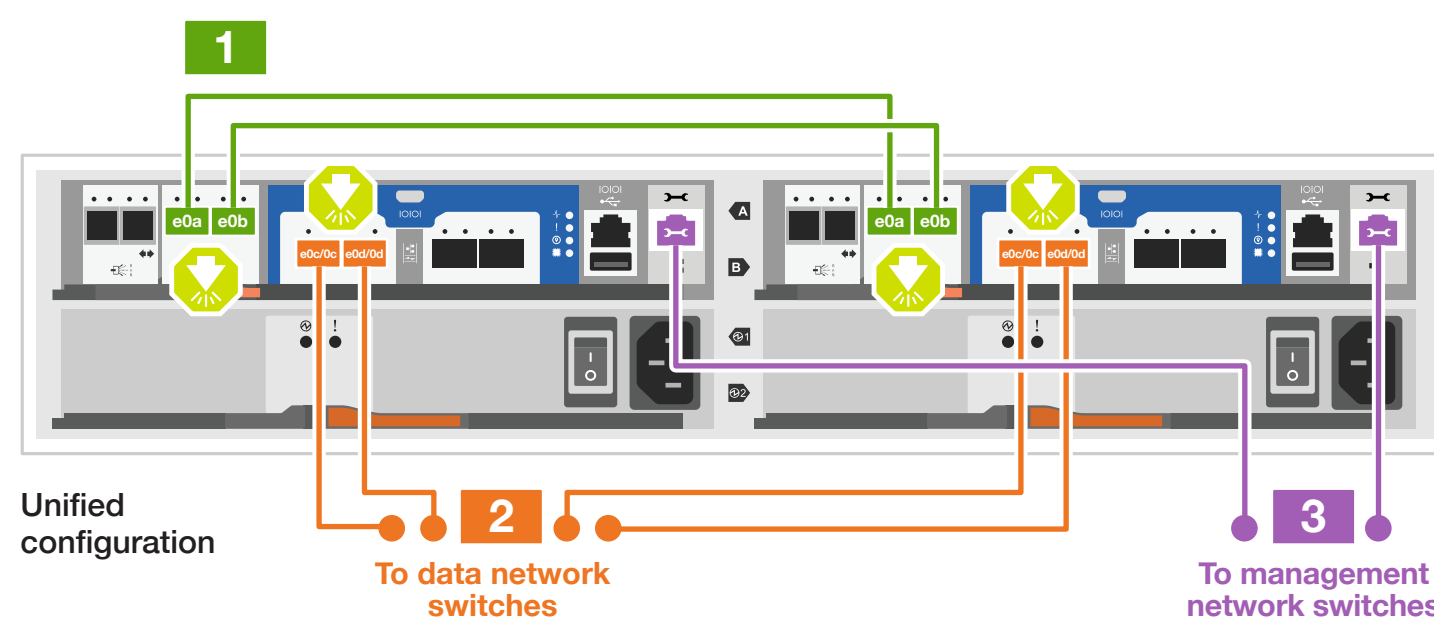

Switched cluster

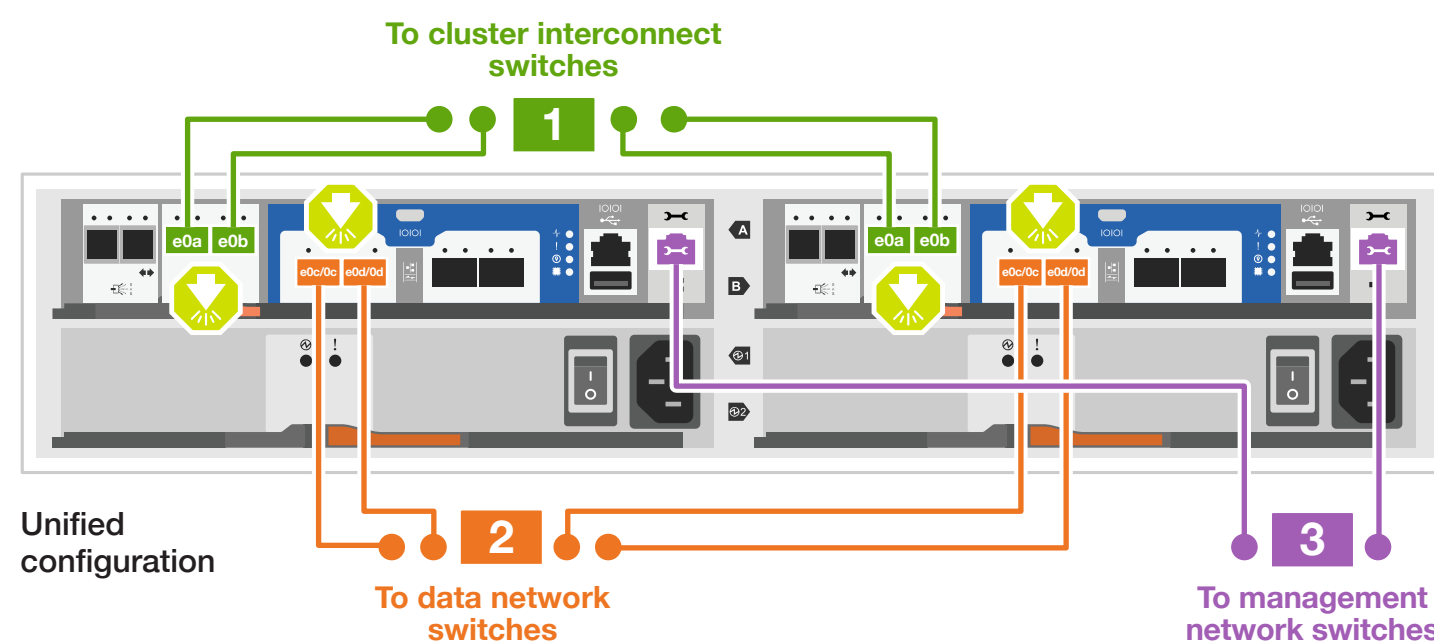

Cable controllers | Stage 2

Attention: Be sure to check the illustration arrow for the proper cable connector pull-tab orientation.
Note: To unplug a cable, gently pull the tab to release the locking mechanism.

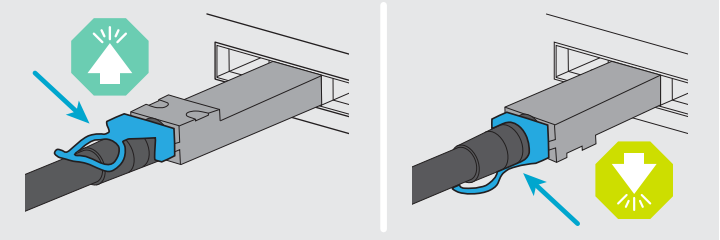

2 Cable the storage

Cable to two DS224C drive shelves

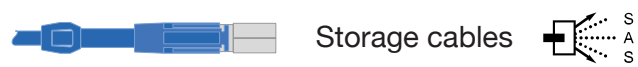

Use the tables below to connect your controllers to the three DS224C shelves.

Note: See [SAS cabling rules, worksheets, and examples overview - shelves with IOM12/IOM12B modules](#) for cabling worksheets and additional cabling examples.

Shelf to shelf

Shelf 1				Shelf 2			
IOMA		IOMB		IOMA		IOMB	
1	3	1	3	1	3	1	3

Shelf to controllers		Shelf 1				Shelf 2				
		IOMA		IOMB		IOMA		IOMB		
Controller	A	0a	1	3	1	3	1	3	1	3
		0b1	1	3	1	3	1	3	1	3
	B	0a	1	3	1	3	1	3	1	3
		0b1	1	3	1	3	1	3	1	3

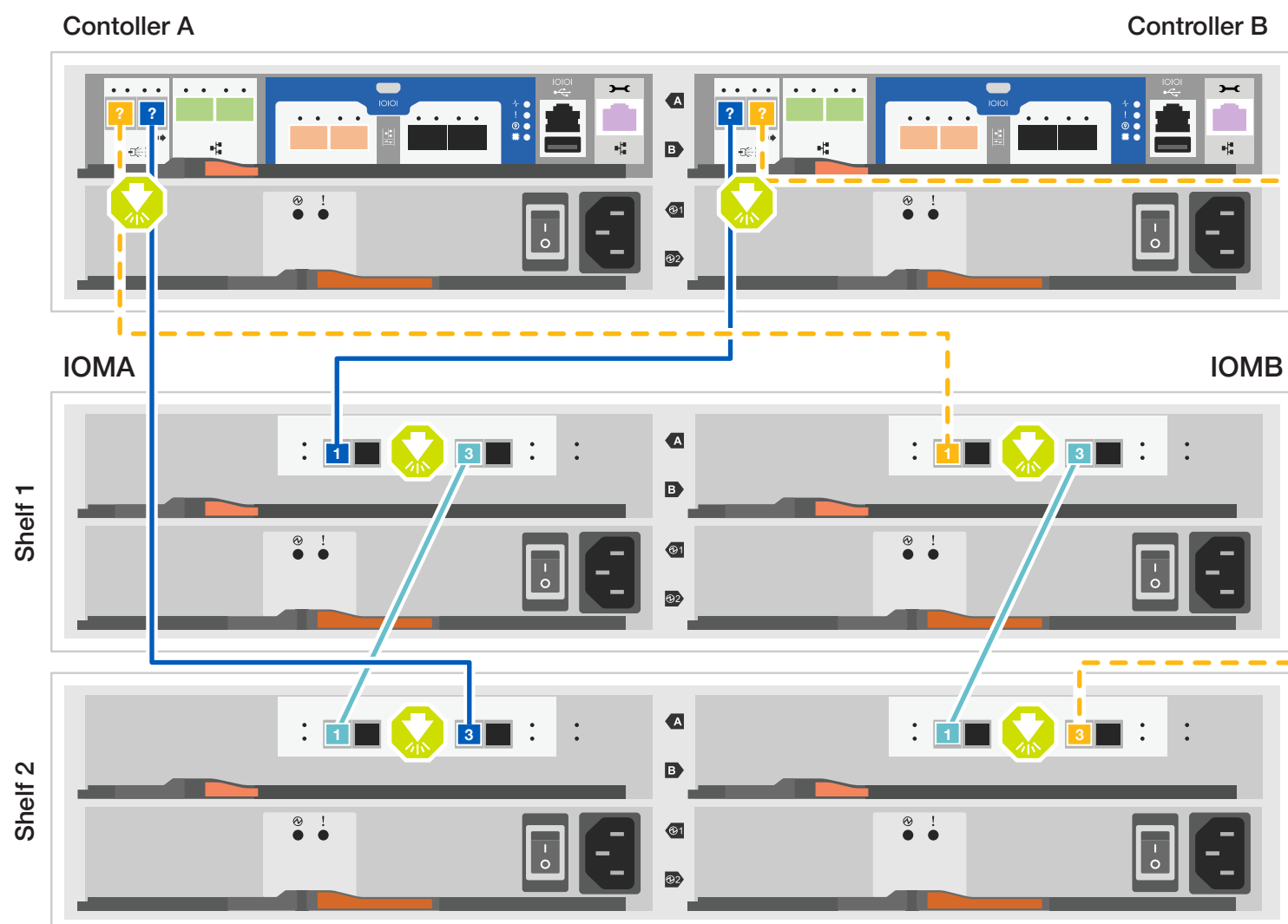

Storage system bring-up | Stage 3

1 Power on the shelves and set shelf IDs

1. Plug the power cords into the shelf power supplies, and then connect them to power sources on different circuits.
2. If you need to change the shelf ID's, see [Change a shelf ID - DS224 shelves](#) for detailed instructions.

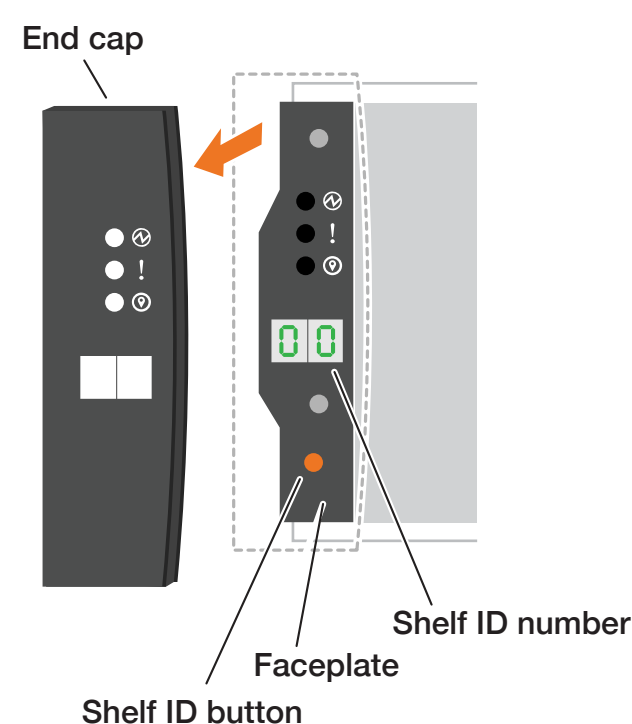

2 Connect both power cords



1. Connect the power cables to each controller's power supply, and then to power sources on different circuits.
2. Secure the power cables using the securing device on each power supply.
3. Turn on the power switches to all nodes.



3 Complete the initial cluster setup with network discovery

Note: If your laptop does not support network discovery, see the [Detailed steps](#).

Connect your laptop to the management switch and access the network computers and devices.

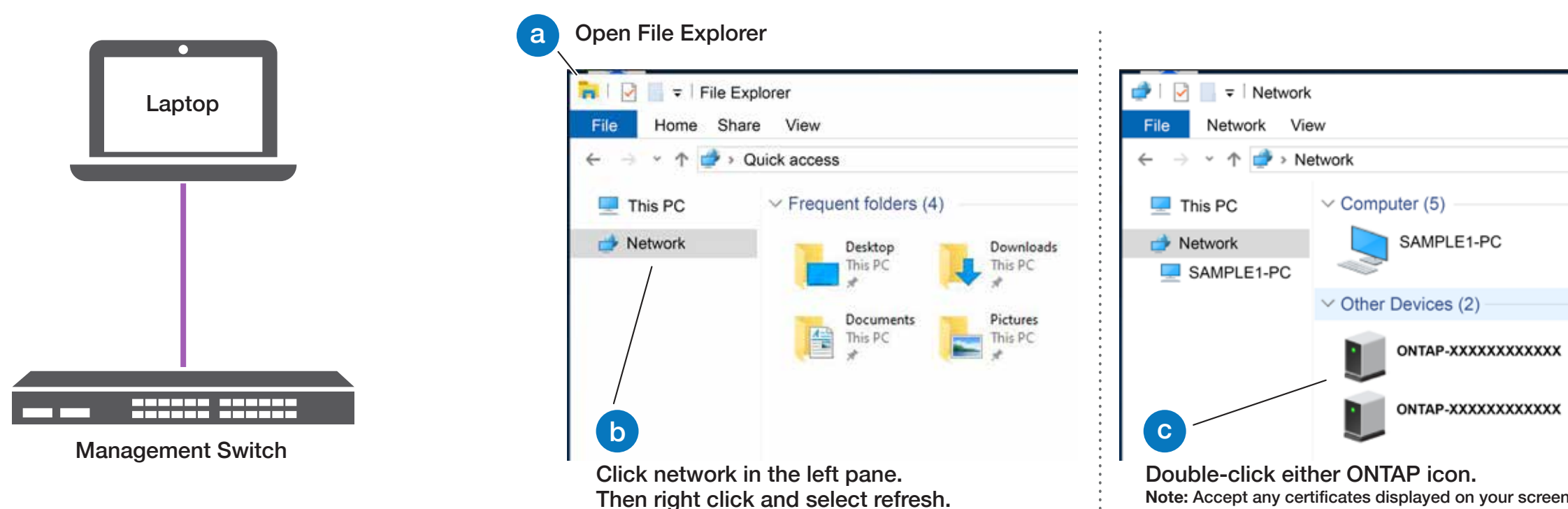

4 Configure your cluster using the [Configure ONTAP on a new cluster with System Manager](#) procedure

5 Complete the setup

1. Click...
 - a) [mysupport.netapp.com](#)
 - b) [Create/log in to your account](#)
 - c) [Register your system](#)
2. [Download and install Active IQ Config Advisor](#), and then run it to verify the health of your storage system.
3. After you have completed the initial configuration, go to the [NetApp ONTAP Resources](#) page for information about configuring additional features in ONTAP.