

FAS9500 Systems

Installation and Setup Instructions



Prepare for installation | Stage 1

Pre-setup

- Unpack all boxes and inventory contents.
Attention: Customers with specific power requirements must check [Hardware Universe](#) for their configuration options.
- Watch the [Setup Videos](#).
- Review the [NetApp ONTAP Configuration Guide](#).

Contents
In the box

Cables in your shipment are order-dependent. Not all cables shown may be in your shipment.

Note: For more cable information and part numbers, see the [Hardware Universe](#).

25 GbE data cable Network cable	32 Gb FC (SFP+ Op) FC optical network cable	Optical network cable Ethernet, FC optical connections	Additional cables
Part numbers: X66240A-05 0.5m, X66240A-2 2m, X66240A-5 5m	Part numbers: X66250-2 2m, X66250-5 5m, X66250-15 15m	Part number X6553-R6 2m, X6554-R6 15m	Ethernet cables Power cables
40 GbE network cable Ethernet data, cluster network	100 GbE network cable NVMe storage, Ethernet data, cluster network	Mini-SAS HD cable Storage connections	Slide rail kit
Part numbers: X66100-1 1m, X66100-3 3m, X66100-5 5m	Part numbers: X66211A-05 0.5m, X66211B-1 1m, X66211B-2 2m, X66211B-5 5m	Part number X-26004-00 1m, X-26005-00 2m, X66033A 3m	Cable management arms

You provide

Rack space 8U per chassis	Screwdriver Phillips #2	Additional network cables For connecting your storage system to your network switch and laptop or console.	Laptop or console With a USB/serial connection and access to a Web browser to configure your storage system

Install hardware | Stage 2

1 Install system in a rack or cabinet:

- Install rail kits, as needed, using the rail kit installation instructions.
- Install the empty chassis into the system cabinet or rack.
- Reinstall the system components into the chassis, matching the chassis slot ID with the slot ID sticker on the component.
- Attach cable management arms.
- Place the bezel on the front of the system.

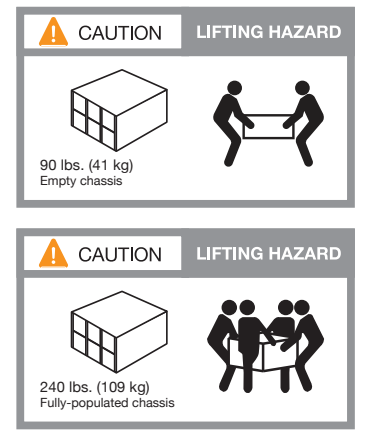
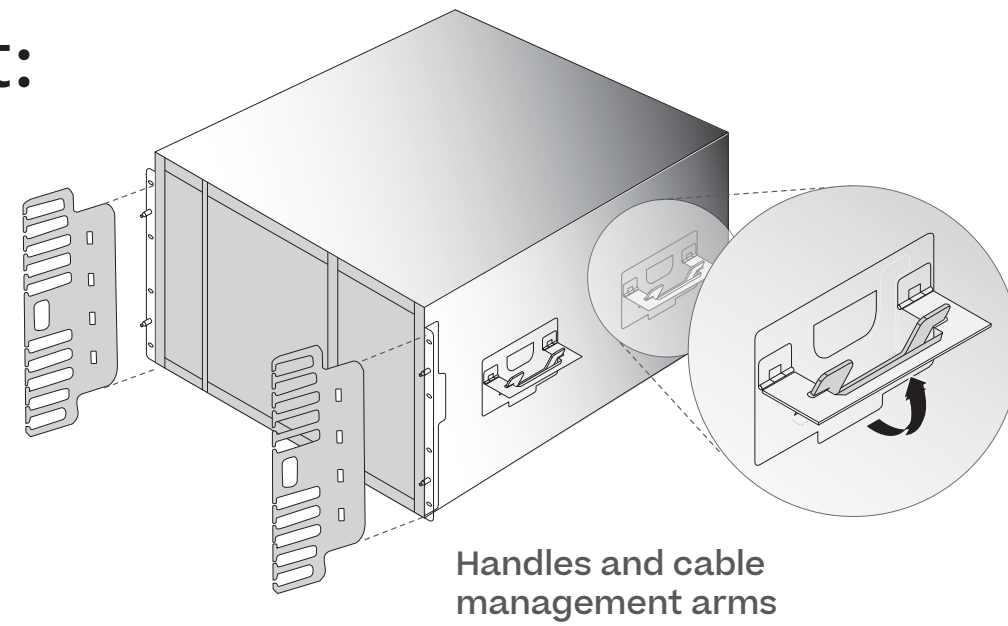

2 Cable controller for a switchless or switched cluster:

See your network administrator for help connecting to your switches.



- 1 Switchless cluster:** Cable cluster interconnect **a** ports together in slot A4 and B4 (e4a) and again in slot A8 and B8 (e8a).

Switched cluster: Cable cluster interconnect **a** ports in slot A4 and B4 (e4a) and again in slot A8 and B8 (e8a) to the cluster network switch.



- 2** Connect the wrench ports to the management switches.



- 3** Cable ports in slot A3 and B3 (e3a and e3c) and slot A9 and B9 (e9a and e9c) to the 32 GbE network switches.



Cable host-side **b** ports in slot A4 and B4 (e4b) and slot A8 and B8 (e8b) to the host switch.



- 4** Cable ports in slot A5 and B5 (5a, 5b, 5c, and 5d) and slot A7 and B7 (7a, 7b, 7c, and 7d) to the 25 Gb FC network switches.

- 5** Strap the cables to the cable management arms (not shown).



- 6** Connect the power cables to the PSUs and connect them to different power sources (not shown).

PSU 1 and PSU 3 provide power to all side A FRUs, PSU 2 and PSU 4 provide power to all side B FRUs.

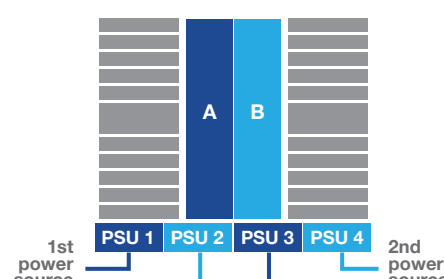

DO NOT power on controllers at this point.

Switchless cluster

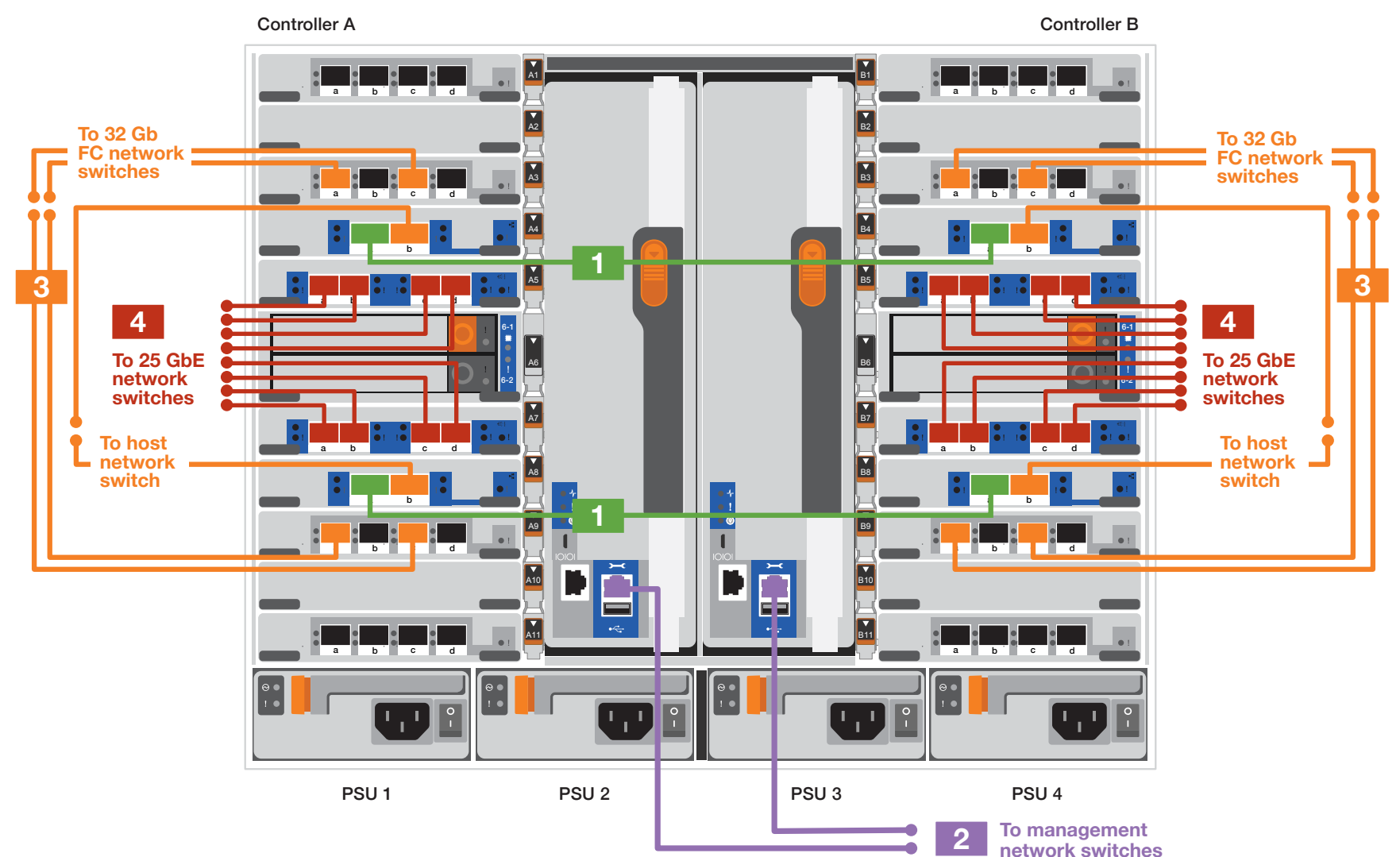

Switched cluster

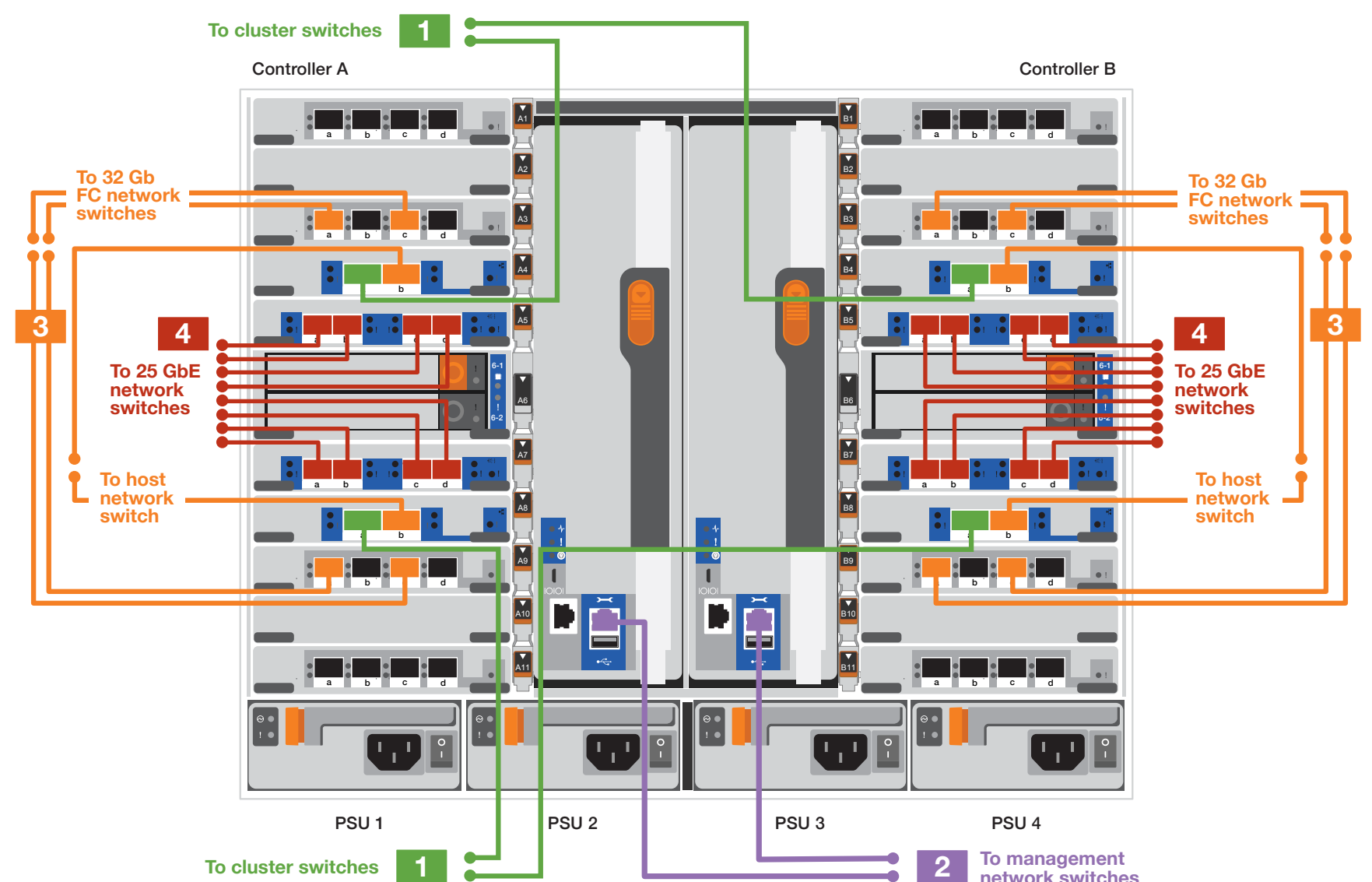

Cable storage | Stage 3

Cabling an FAS9500 with three DS224C disk shelves

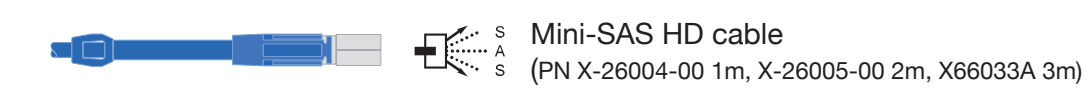

Note: For more SAS cabling information, see [SAS cabling rules, worksheets, and examples overview - shelves with IOM12 modules](#)

Insert SAS cable tab **UP** or tab **DOWN** and gently push into place until it clicks.

- 1
- Connect the shelf-to-shelf ports
- 2
- Connect controllers to Stack 1.
- 3
- Connect controllers to Stack 2.

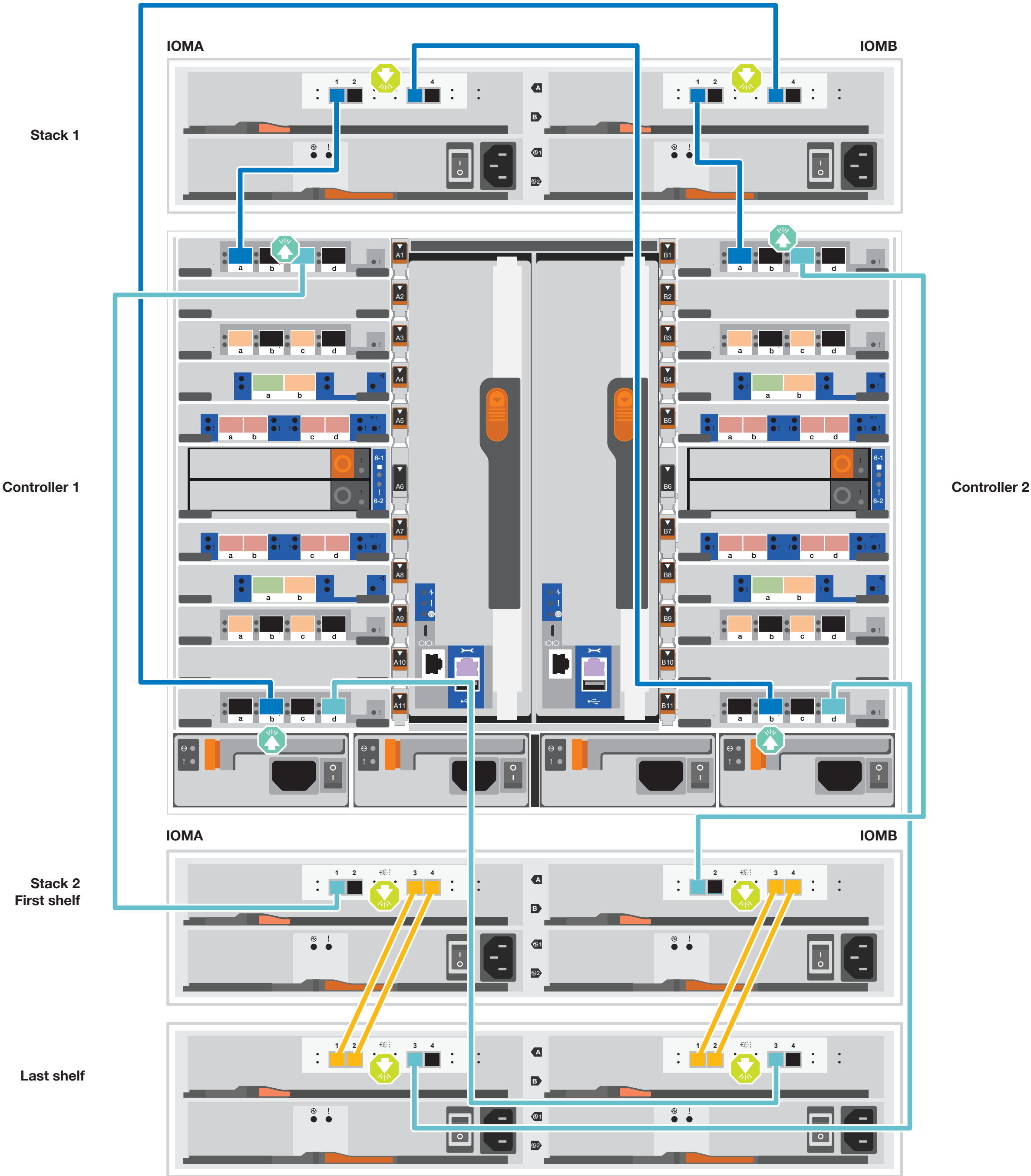

Complete system setup and configuration | Stage 4

1 Power on the shelves and set shelf IDs:

1. Plug the power cords into the shelf power supplies, and then connect them to power sources on different circuits.

Note: Turn on the power switch to boot the shelves.

2. If you need to change the shelf IDs, continue with substeps a through e; otherwise, skip to “Power on the controllers” below.

Repeat these steps for any remaining drive shelves.

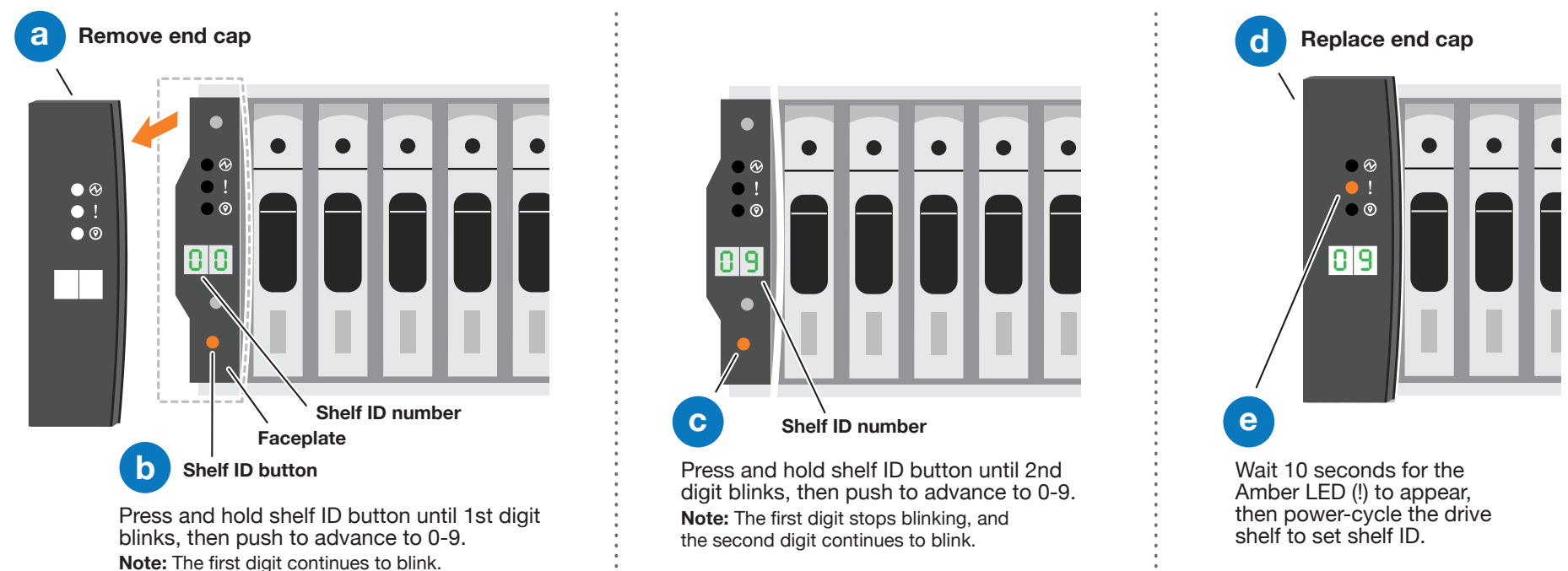

2 Turn on the power switches to all nodes:

PSU 1 and PSU 3 provide power to all side A FRUs, PSU 2 and PSU 4 provide power to all side B FRUs.

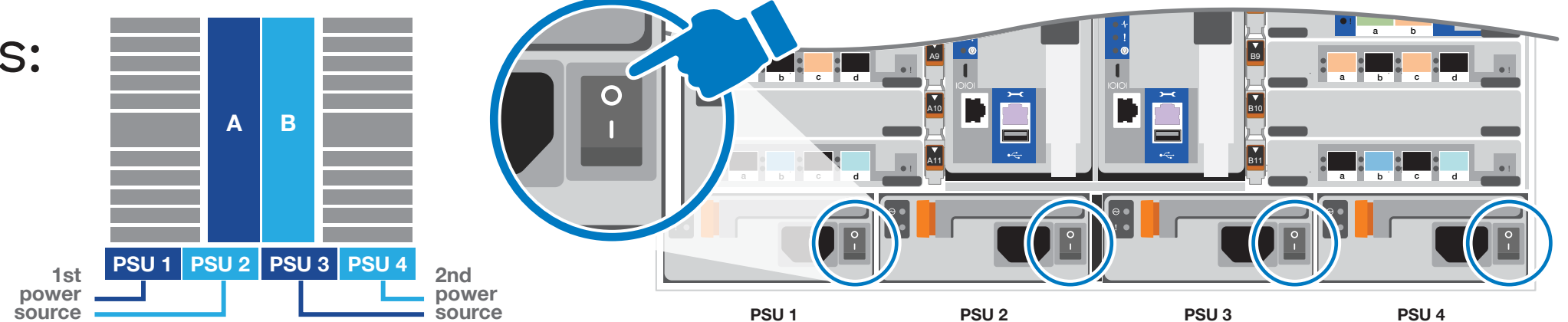

3 Complete initial cluster setup with network discovery:

Note: If your laptop does not support network discovery, see the [Detailed guide](#).

Connect your laptop to the management switch and access the network computers and devices.

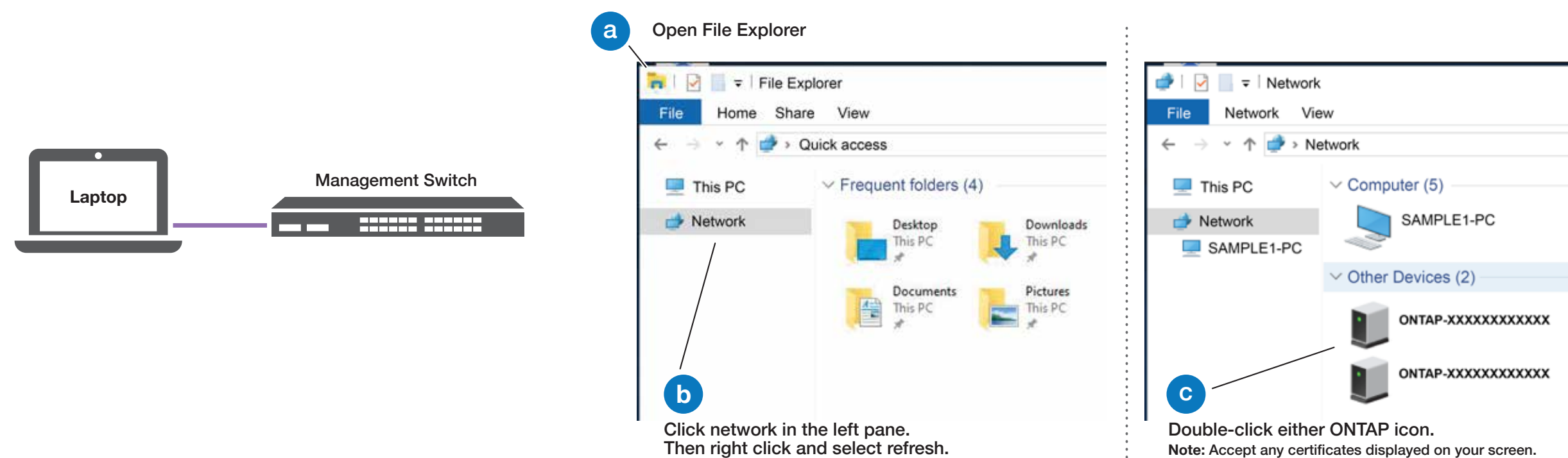

4 Use System Manager Guided Setup to configure your cluster.

5 Completing setup:

1. Click...
 - a) mysupport.netapp.com
 - b) [Create/log in to your account](#)
 - c) [Register your system](#)
2. Download and install Active IQ Config Advisor. Verify the health of your system by running Config Advisor.
3. After you have completed the initial configuration, go to the [NetApp ONTAP Resources](#) page for information about configuring additional features in ONTAP.