

# FAS2800 Systems Installation and Setup Instructions



## Prepare and install | Stage 1



### Pre-setup

1. Unpack all boxes and inventory contents.  
**Attention:** Customers with specific power requirements must check [Hardware Universe](#) for their configuration options.
  2. Gather information about your storage system by completing the cluster setup worksheets:  
[Get started with ONTAP cluster set up](#).
  3. Review the requirements and procedure steps for [Configure ONTAP on a new cluster with System Manager](#).
- Note:** For MetroCluster configurations, use the [MetroCluster installation content](#).



### Contents in the box

Cables shown are the most common. See [Hardware Universe](#) for more options.

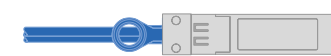

#### 10 Gb Ethernet, SFP28 Network cable

Part numbers X6566B-05-R6, .5m;  
X6566B-2-R6, 2m



#### 10 GBASE-T, RJ45 Network cable

Part numbers X6561-R6;  
X6562-R6



#### 32 Gb Fiber Channel, SFP+ (target/initiator) Network cable

Part numbers X66250-2, 2m;  
X66250-5, 5m; X66250-15, 15m

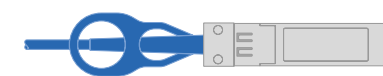

#### 25 Gb Ethernet, SFP28 Network cable

Part numbers X66240A-05, .5m;  
X66240-2, 2m; X66240A-5, 5m

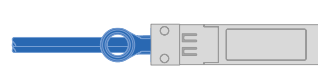

#### MiniSAS HD cable Storage connections

Part numbers X66030A, 0.5m;  
X66031A, 1m; X66032A, 2m

#### Additional cables

##### Ethernet cables



##### Power cables



#### Cable management tray

#### Slide rail kit



### You provide



#### Rack space

2U for platform  
+2U for each DS224C  
or DS212 shelf



#### Screwdriver

Phillips #2



#### Additional network cables

For connecting your storage system  
to your network switch and laptop  
or console



#### Laptop or console

With a USB/serial connection  
and access to a Web browser to  
configure your storage system



### Install storage system in a rack or cabinet

**Attention:** Airflow through the platform and shelves enters from the front where the bezel or end caps are installed and exhausts out the rear where the ports are located.

1. Install rail kits for the platform and shelves, as needed, using the instructions included with the kits.
2. Install the platform chassis into the rack or cabinet.
3. Attach the cable management devices to the rear of the platform.
4. Install the bezel on the front of the platform.
5. Install any drive shelves into the rack or cabinet.

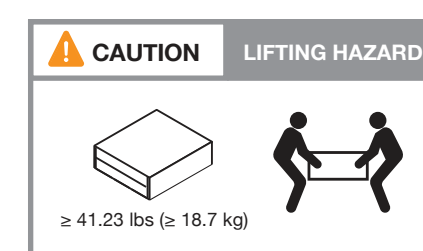
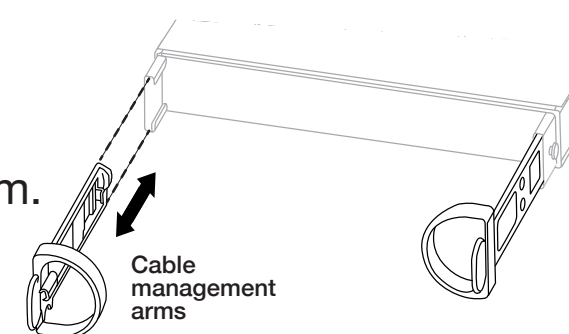

# Cable controllers | Stage 2

**Attention:** Be sure to check the illustration arrow for the proper cable connector pull-tab orientation.  
**Note:** To unplug a cable, gently pull the tab to release the locking mechanism.

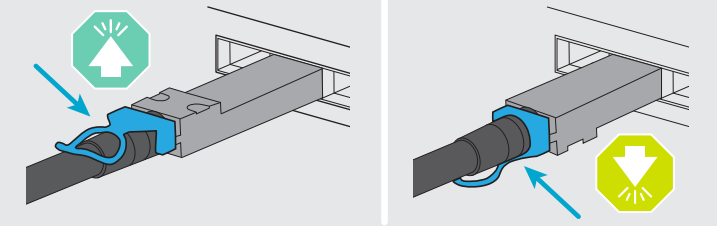

## 1 Cable the controllers for a switchless or switched cluster

See your network administrator for help connecting to your switches.



Cluster interconnect cables

### 1 Switchless cluster

Cable port e0a to port e0a and port e0b to port e0b. (Part # X66240A-05, .5m)

### Switched cluster

Cable port e0a and port e0b on each controller to the cluster interconnect switches.



Ethernet cables

2 Connect the wrench port (e0M/BMC) to the management switches.

3 Cables used are dependent on what mezzanine card is installed. See page 1 for cable part numbers and descriptions and match them to the cables in your shipment.



- 4-ports, 10/25 Gb Ethernet, SFP28
- 4-ports, 32 Gb Fiber Channel, SFP+ (target only)
- 4-ports, 32 Gb Fiber Channel, SFP+ (initiator/target)
- 4-ports, 10 GBASE-T, RJ45

Cable ports e1a through e1d to your Ethernet data network or ports e1a through e1d for your FC network.

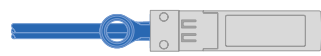

2-ports, 10/25 Gb Ethernet (SFP28) + 2-ports 32 Gb FC (SFP+)

Cable ports 1a and 1b to your FC data network and ports e1c and e1d to your Ethernet data network.

4 Strap the cables to the cable management arms (not shown).

## Switchless cluster

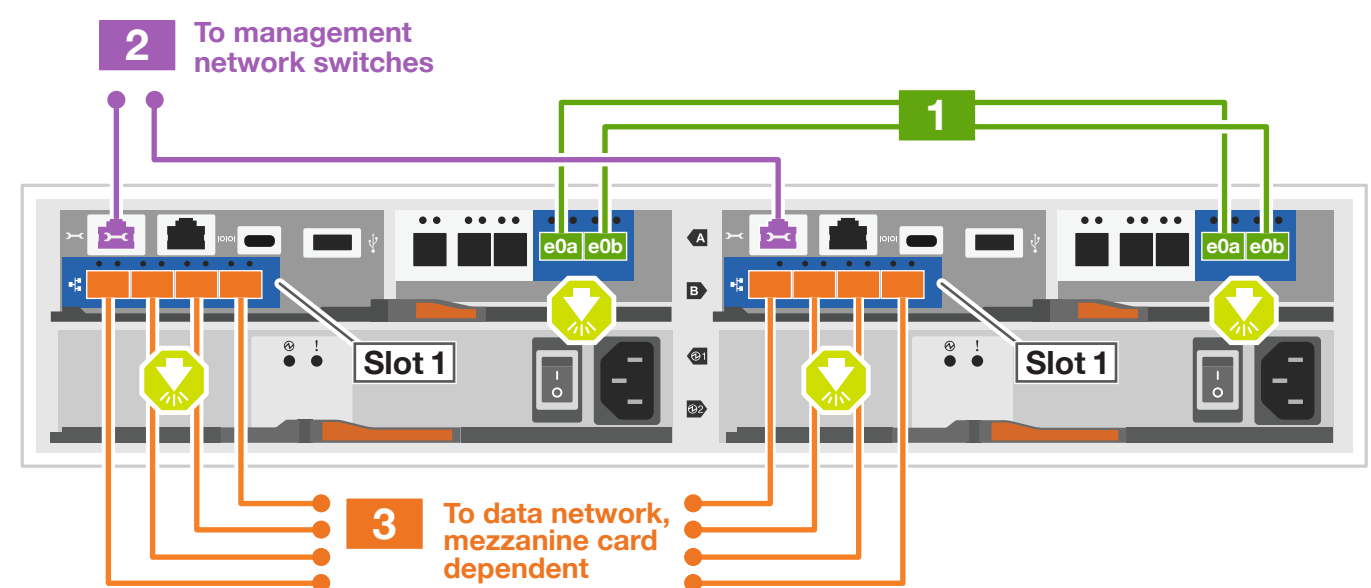

## Switched cluster

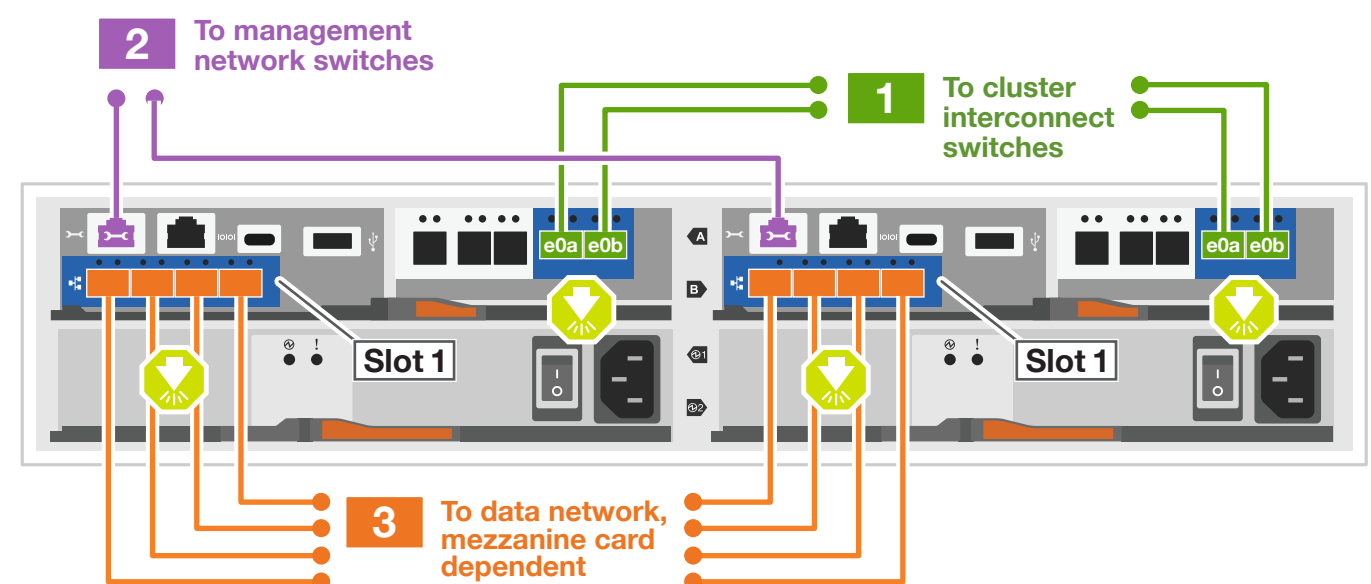

# Cable controllers | Stage 2

**Attention:** Be sure to check the illustration arrow for the proper cable connector pull-tab orientation.  
**Note:** To unplug a cable, gently pull the tab to release the locking mechanism.

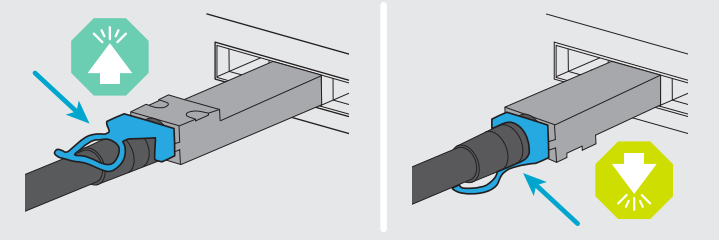

## 2 Cable storage

### Cable to three DS224C or DS212 drive shelves

**Note:** See [SAS cabling rules, worksheets, and examples overview - shelves with IOM12/IOM12B modules](#) for cabling worksheets and additional cabling examples.



Use the tables below to connect your controllers to the three DS224C shelves.

Shelf to shelf

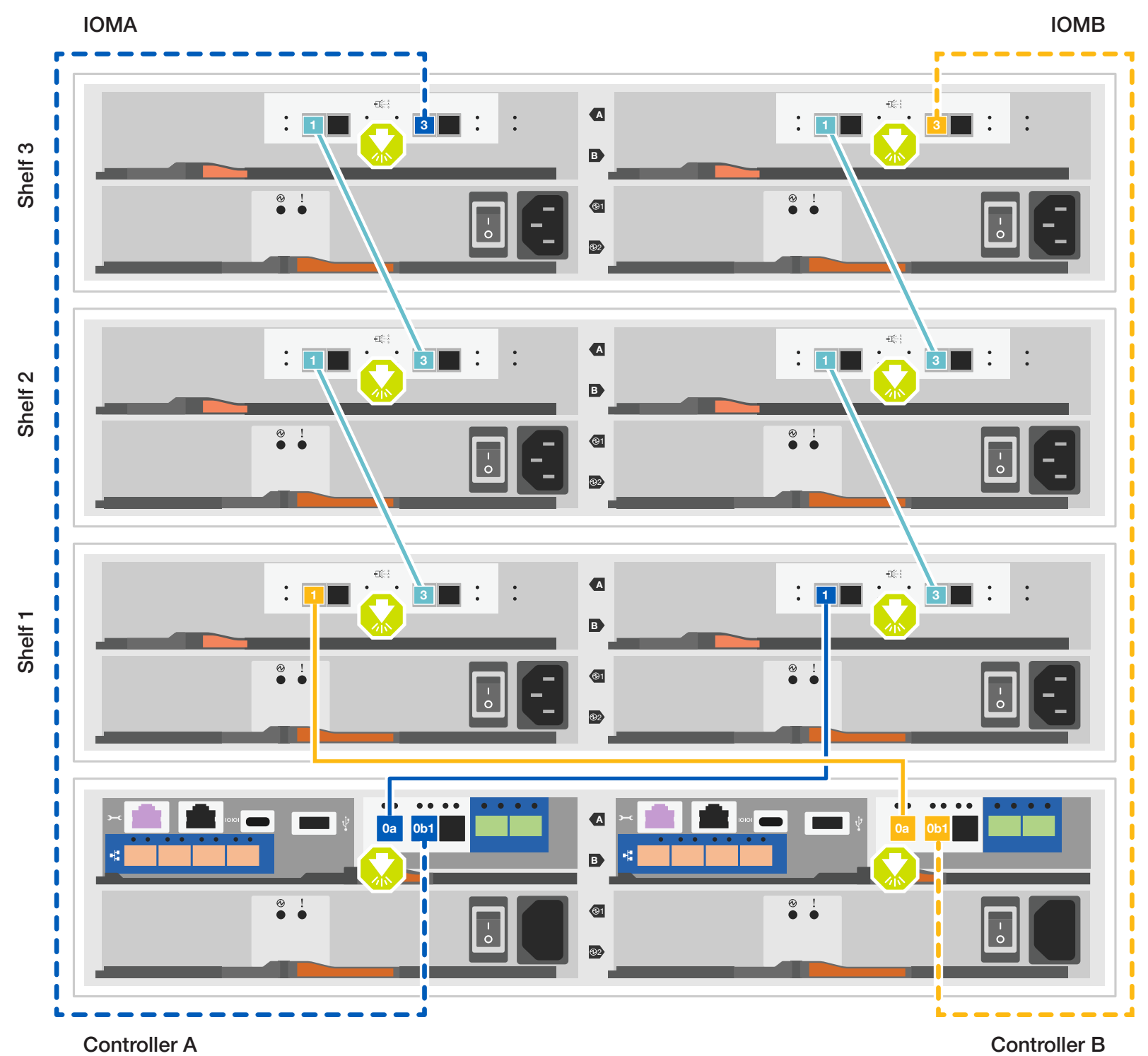
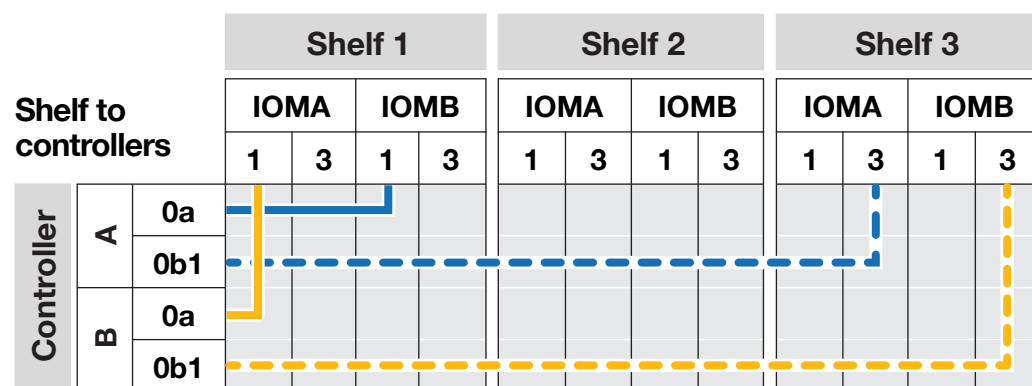
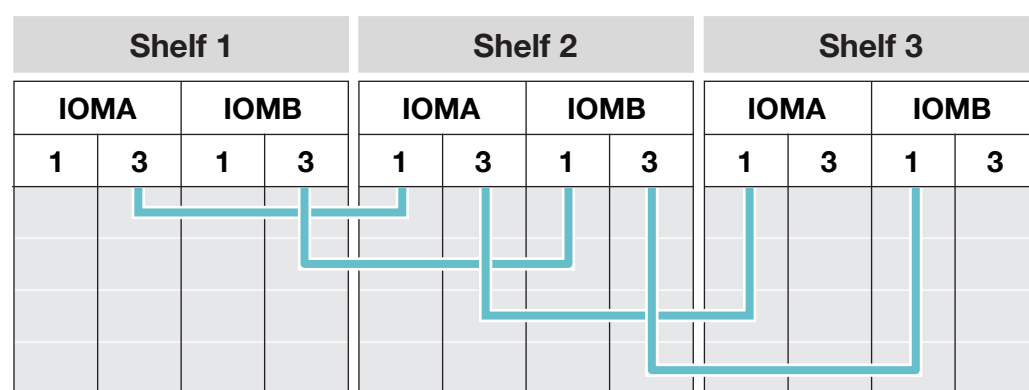

# Storage system bring-up | Stage 3

## 1 Power on the shelves and set shelf IDs

1. Plug the power cords into the shelf power supplies, and then connect them to power sources on different circuits.
2. If you need to change the shelf ID's, see [Change a shelf ID - DS224 shelves](#) for detailed instructions.

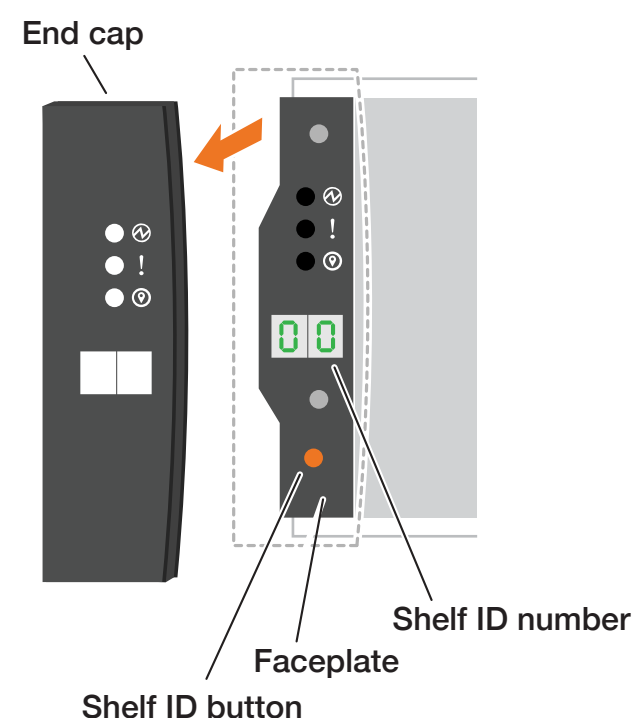

## 2 Connect both power cords



1. Connect the power cables to each controller's power supply, and then to power sources on different circuits.
2. Secure the power cables using the securing device on each power supply.
3. Turn on the power switches to all nodes.



## 3 Complete the initial cluster setup with network discovery

**Note:** If your laptop does not support network discovery, see the [Detailed steps](#).

Connect your laptop to the management switch and access the network computers and devices.

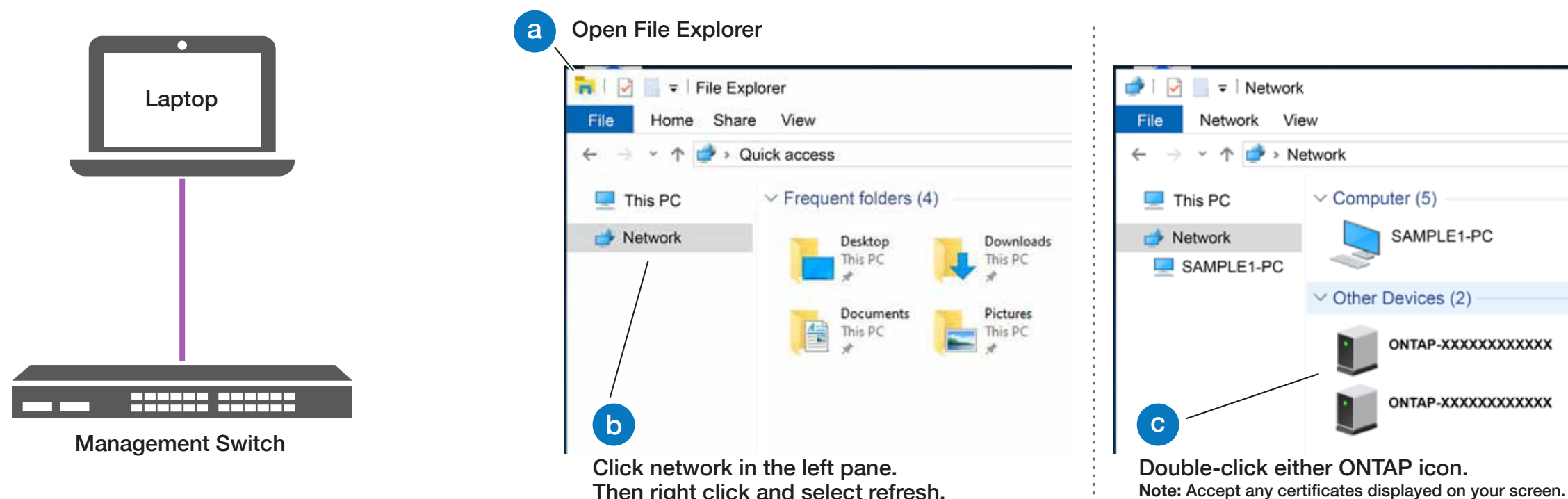

## 4 Configure your cluster using the [Configure ONTAP on a new cluster with System Manager](#) procedure

## 5 Complete the setup

1. Click...
  - a) [mysupport.netapp.com](#)
  - b) [Create/log in to your account](#)
  - c) [Register your system](#)
2. [Download and install Active IQ Config Advisor](#), and then run it to verify the health of your storage system.
3. After you have completed the initial configuration, go to the [NetApp ONTAP Resources](#) page for information about configuring additional features in ONTAP.