



Concepts

Cloud Sync

NetApp
April 12, 2021

Table of Contents

- Concepts 1
 - Cloud Sync overview 1
 - How Cloud Sync works 1
 - How Cloud Sync licenses work 2
- Accounts 3
- Data privacy 4

Concepts

Cloud Sync overview

The NetApp Cloud Sync service offers a simple, secure, and automated way to migrate your data to any target, in the cloud or on your premises. Whether it's a file-based NAS dataset (NFS or SMB), Amazon Simple Storage Service (S3) object format, a NetApp StorageGRID® appliance, or any other cloud provider object store, Cloud Sync can convert and move it for you.

Watch the following video for an overview of Cloud Sync:

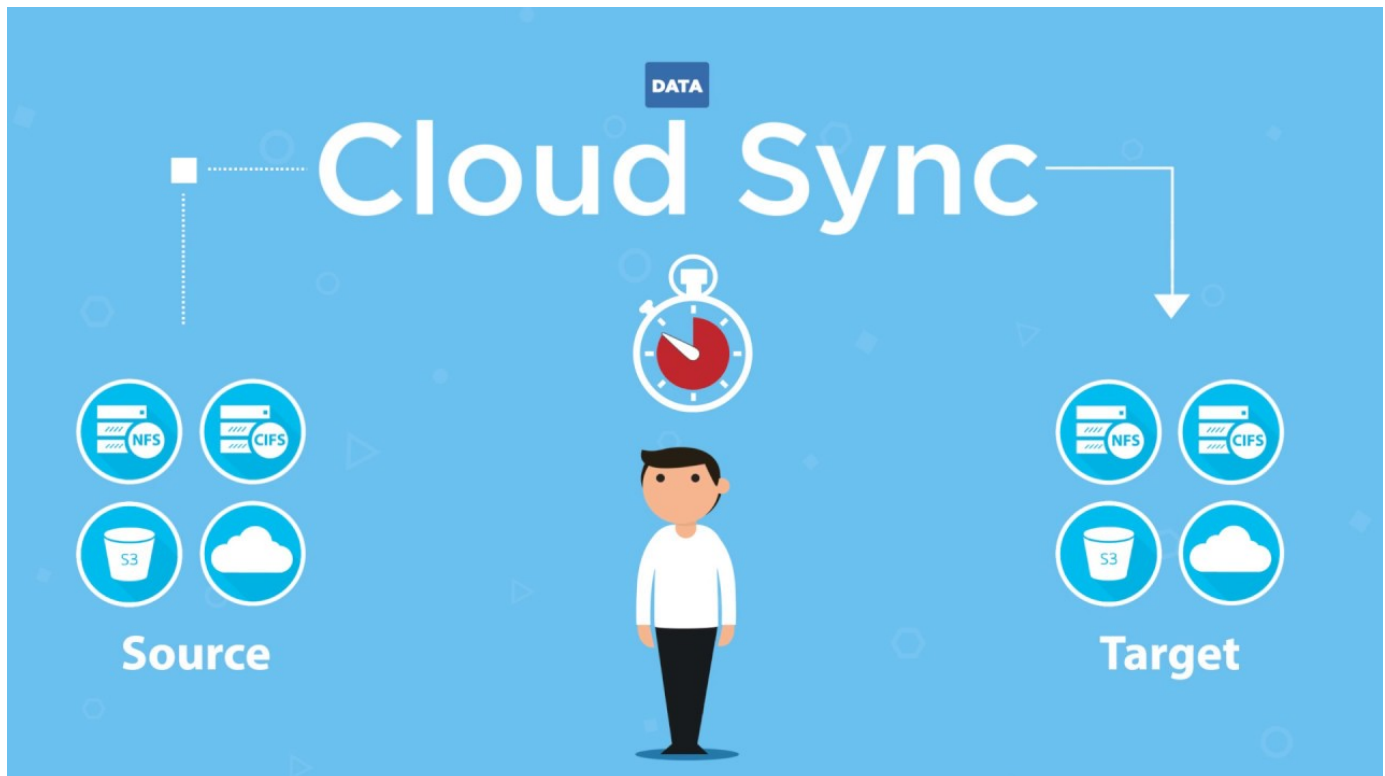

For more details about the value that Cloud Sync provides, [read the datasheet](#).

How Cloud Sync works

Cloud Sync is a software-as-a-service (SaaS) platform that consists of a data broker, a cloud-based portal, and a source and target.

The following image shows the relationship between Cloud Sync components:

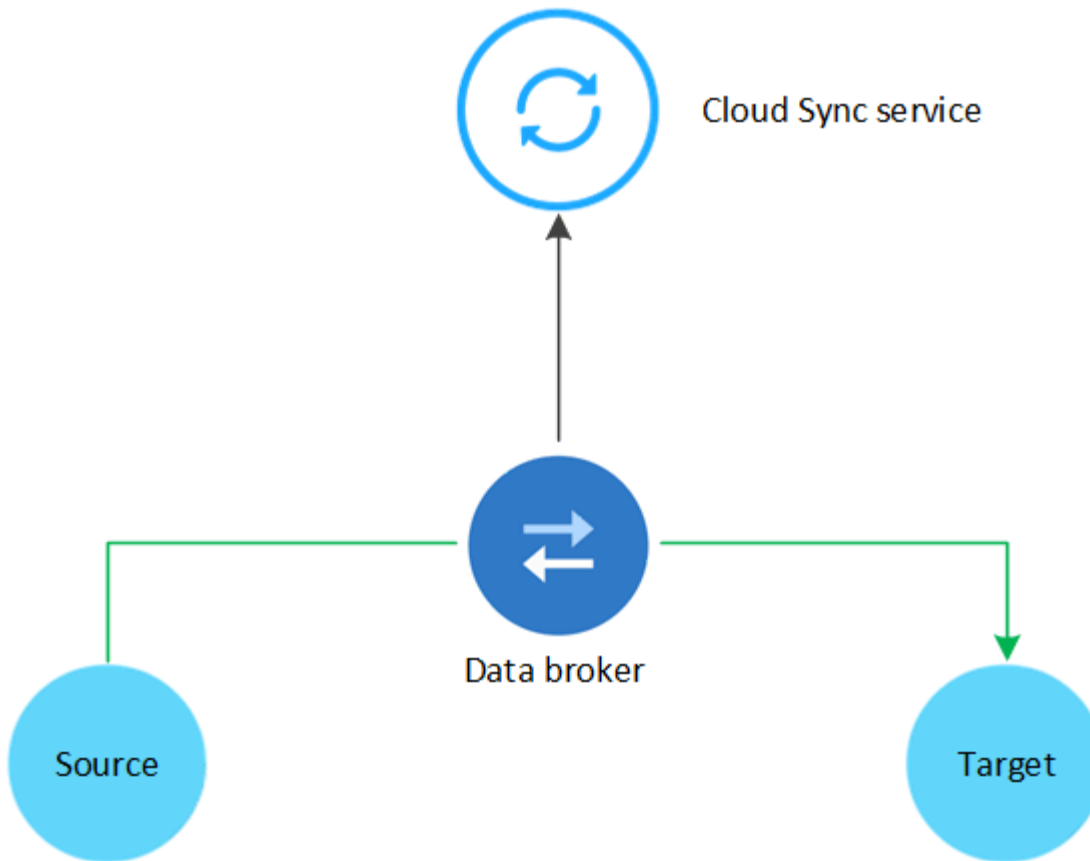

The NetApp data broker software syncs data from a source to a target (this is called a *sync relationship*). You can run the data broker in AWS, Azure, Google Cloud Platform, or on your premises. The data broker needs an outbound internet connection over port 443 so it can communicate with the Cloud Sync service and contact a few other services and repositories. [View the list of endpoints.](#)

After the initial copy, the service syncs any changed data based on the schedule that you set.

How Cloud Sync licenses work

There are two ways to pay for sync relationships after your 14-day free trial ends. The first option is to subscribe from AWS or Azure, which enables you to pay-as-you-go or to pay annually. The second option is to purchase licenses directly from NetApp.

AWS or Azure subscriptions

Subscribing to the Cloud Sync service from AWS or Azure enables you to pay at an hourly rate, or to pay annually. You can subscribe through either AWS or Azure, depending on where you want to be billed.

Pay-as-you-go subscriptions

With a pay-as-you-go subscription, the Cloud Sync service charges hourly based on the number of sync relationships that you create. For pricing details, go to the [Cloud Sync service page](#).

Annual subscriptions

An annual subscription provides a license for 20 sync relationships that you pay for up front.

If you go above 20 sync relationships and you've subscribed through Azure, you pay for the additional relationships by the hour.

- [View pay-as-you-go pricing in AWS](#)
- [View annual pricing in AWS](#)
- [View pricing in Azure](#)
- [Learn how to subscribe through AWS or Azure](#)

Licenses from NetApp

Another way to pay for sync relationships up front is by purchasing licenses directly from NetApp. Each license enables you to create up to 20 sync relationships.

You can use these licenses with an AWS or Azure subscription. For example, if you have 25 sync relationships, you can pay for the first 20 sync relationships using a license and then pay-as-you-go from AWS or Azure with the remaining 5 sync relationships.

[Learn how to purchase licenses and add them to Cloud Sync.](#)

License terms

Customers who purchase a Bring Your Own License (BYOL) to the Cloud Sync service should be aware of limitations associated with the license entitlement.

- Customers are entitled to leverage the BYOL license for a term not to exceed one year from the date of delivery.
- Customers are entitled to leverage the BYOL license to establish and not to exceed a total of 20 individual connections between a source and a target (each a “sync relationship”).
- A customer’s entitlement expires at the conclusion of the one-year license term, irrespective as to whether Customer has reached the 20 sync relationship limitation.
- In the event the Customer chooses to renew its license, unused sync relationships associated from the previous license grant DO NOT roll over to the license renewal.

Accounts

Each Cloud Central user is associated with one or more Cloud Central accounts. An account enables multi-tenancy: multiple users can manage the sync relationships in a single account.

For example, two users might be associated with the same Cloud Central account. Both of those users can see the same sync relationships and data brokers that are created in that account.

But if those two users are associated with *separate* Cloud Central accounts, then the users would only see the sync relationships and data brokers in the account that they are associated with.

If a user is associated with multiple Cloud Central accounts, you can change to a different account at any time from the User Settings menu in Cloud Sync.

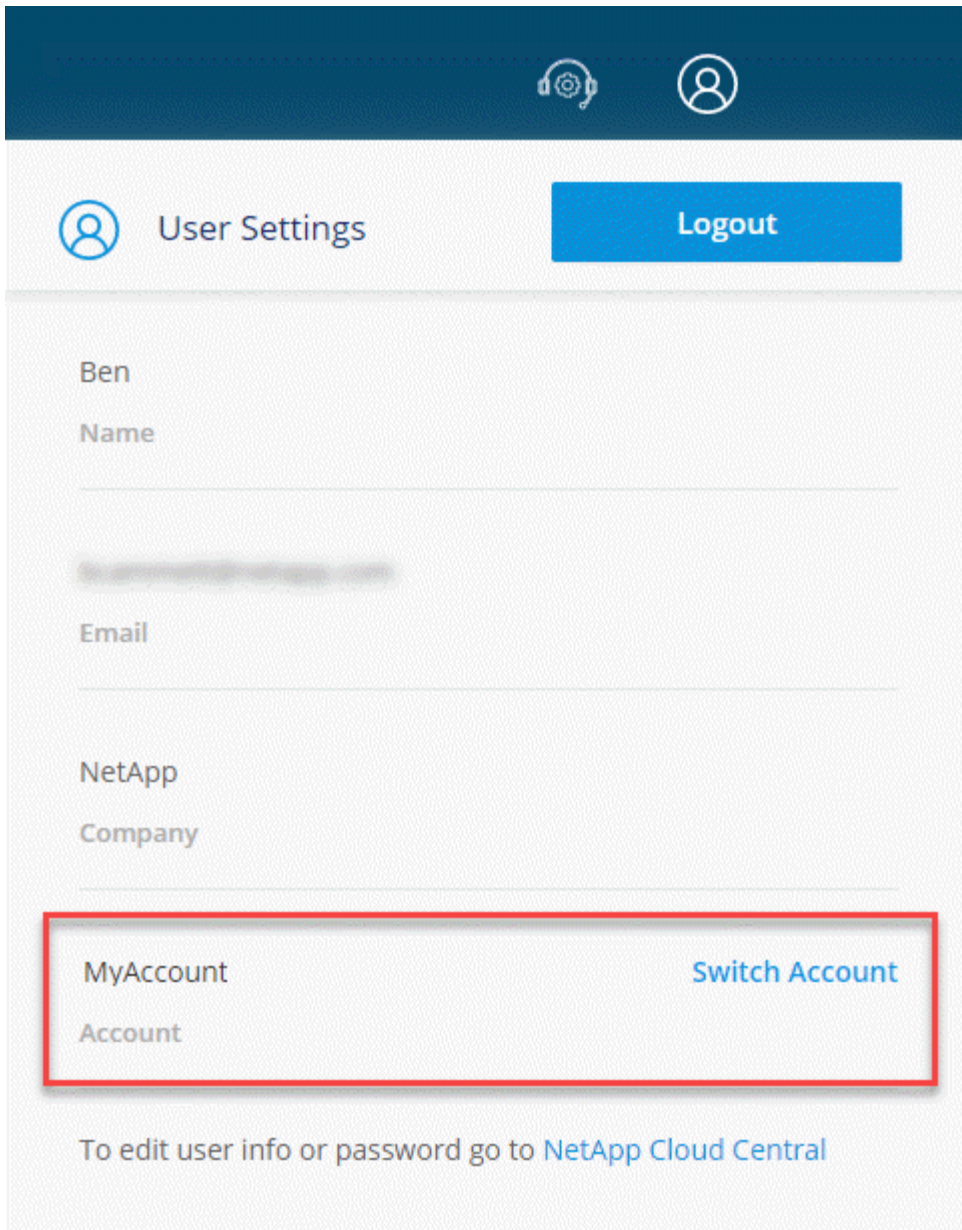

If you want to associate a user to a specific account, you can use Cloud Central APIs, Cloud Manager's user interface, or contact us for help using the in-product chat.

[NetApp Cloud Central Services API](#)

Data privacy

NetApp doesn't have access to any credentials that you provide while using the Cloud Sync service. The credentials are stored directly on the data broker machine, which resides in your network.

Depending on the configuration that you choose, Cloud Sync might prompt you for credentials when you create a new relationship. For example, when setting up a relationship that includes an SMB server, or when deploying the data broker in AWS.

These credentials are always saved directly to the data broker itself. The data broker resides on a machine in your network, whether it's on premises or in your cloud account. The credentials are never made available to

NetApp.

The credentials are locally encrypted on the data broker machine using HashiCorp Vault.

Copyright Information

Copyright © 2021 NetApp, Inc. All rights reserved. Printed in the U.S. No part of this document covered by copyright may be reproduced in any form or by any means-graphic, electronic, or mechanical, including photocopying, recording, taping, or storage in an electronic retrieval system-without prior written permission of the copyright owner.

Software derived from copyrighted NetApp material is subject to the following license and disclaimer:

THIS SOFTWARE IS PROVIDED BY NETAPP "AS IS" AND WITHOUT ANY EXPRESS OR IMPLIED WARRANTIES, INCLUDING, BUT NOT LIMITED TO, THE IMPLIED WARRANTIES OF MERCHANTABILITY AND FITNESS FOR A PARTICULAR PURPOSE, WHICH ARE HEREBY DISCLAIMED. IN NO EVENT SHALL NETAPP BE LIABLE FOR ANY DIRECT, INDIRECT, INCIDENTAL, SPECIAL, EXEMPLARY, OR CONSEQUENTIAL DAMAGES (INCLUDING, BUT NOT LIMITED TO, PROCUREMENT OF SUBSTITUTE GOODS OR SERVICES; LOSS OF USE, DATA, OR PROFITS; OR BUSINESS INTERRUPTION) HOWEVER CAUSED AND ON ANY THEORY OF LIABILITY, WHETHER IN CONTRACT, STRICT LIABILITY, OR TORT (INCLUDING NEGLIGENCE OR OTHERWISE) ARISING IN ANY WAY OUT OF THE USE OF THIS SOFTWARE, EVEN IF ADVISED OF THE POSSIBILITY OF SUCH DAMAGE.

NetApp reserves the right to change any products described herein at any time, and without notice. NetApp assumes no responsibility or liability arising from the use of products described herein, except as expressly agreed to in writing by NetApp. The use or purchase of this product does not convey a license under any patent rights, trademark rights, or any other intellectual property rights of NetApp.

The product described in this manual may be protected by one or more U.S. patents, foreign patents, or pending applications.

RESTRICTED RIGHTS LEGEND: Use, duplication, or disclosure by the government is subject to restrictions as set forth in subparagraph (c)(1)(ii) of the Rights in Technical Data and Computer Software clause at DFARS 252.277-7103 (October 1988) and FAR 52-227-19 (June 1987).

Trademark Information

NETAPP, the NETAPP logo, and the marks listed at <http://www.netapp.com/TM> are trademarks of NetApp, Inc. Other company and product names may be trademarks of their respective owners.