



Concepts

Converged Systems Advisor

NetApp
June 20, 2025

Table of Contents

- Concepts 1
 - Converged Systems Advisor overview 1
 - How Converged Systems Advisor works 1
- Licensing 2
- Security 3
 - How the data is collected 3
 - How the data is transferred 4
 - How the data is kept secure and private 4
- User roles 5

Concepts

Converged Systems Advisor overview

Converged Systems Advisor validates the deployment of your FlexPod infrastructure and provides continuous monitoring and notifications to ensure business continuity.

Watch the following video for an overview of Converged Systems Advisor:

 | <https://img.youtube.com/vi/CZHu0Xp33BY/maxresdefault.jpg>

For more details about the value that Converged Systems Advisor provides, [read the datasheet](#).

How Converged Systems Advisor works

Converged Systems Advisor is a software-as-a-service (SaaS) platform that consists of an on-premises agent and a cloud-based portal.

The following image shows the relationship between Converged Systems Advisor components:

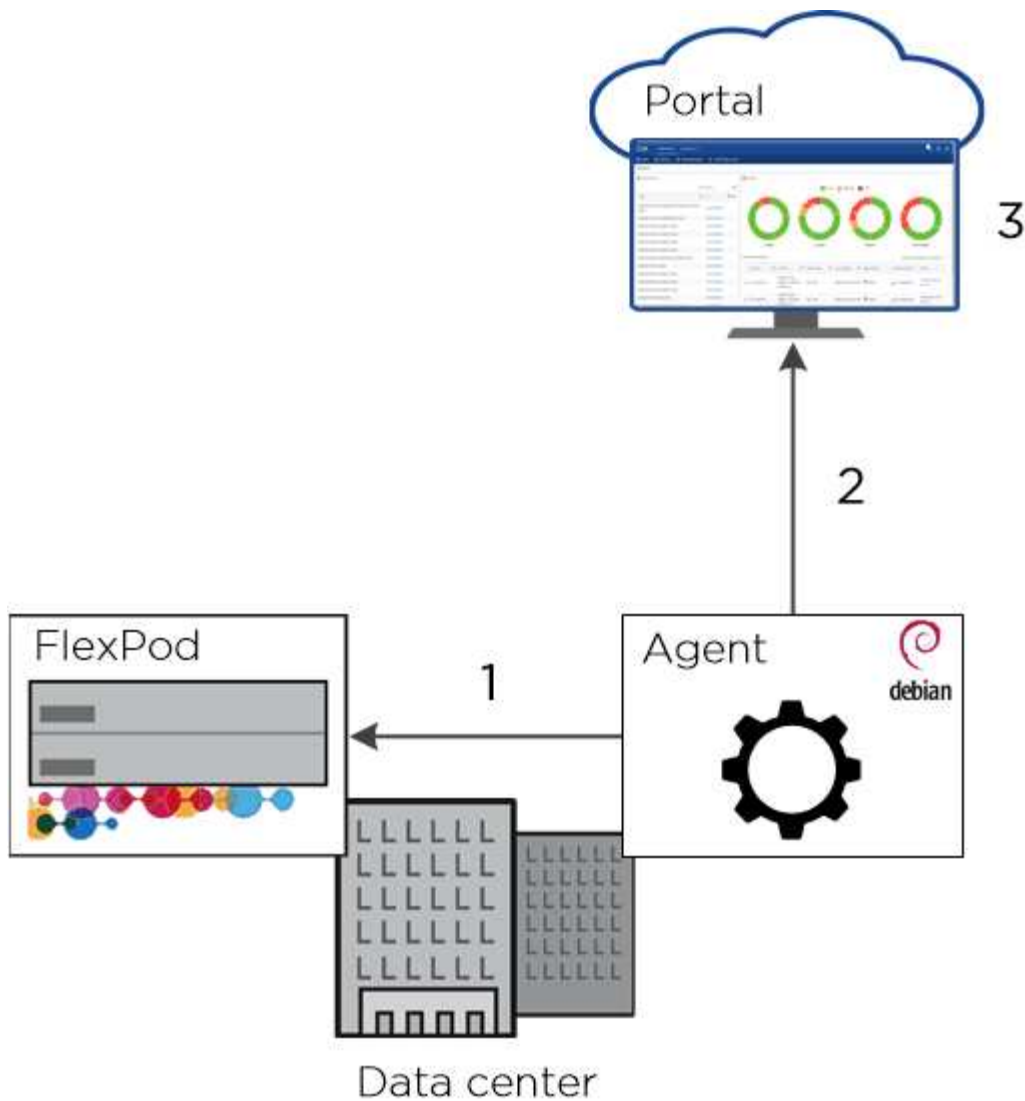

1. The Converged Systems Advisor agent, which resides on your premises, collects configuration data from a FlexPod converged infrastructure using credentials that you provide.
2. The agent sends the data to the Converged Systems Advisor portal.
3. Users log in to the Converged Systems Advisor portal using a web browser to validate, monitor, and optimize their FlexPod converged infrastructure.

[Read how Converged Systems Advisor keeps the data secure.](#)

Licensing

A license is required to unlock features in Converged Systems Advisor. You can choose from a few licensing options for each FlexPod converged infrastructure.

| License | Features | Terms |
|------------|--|--|
| No license | Limited version to demonstrate product capabilities: <ul style="list-style-type: none"> • Monitoring of FlexPod configurations for a 24-hour trial period • Health dashboards to view FlexPod best practice compliance • Limited inventory and remediation (available in licensed versions) | <ul style="list-style-type: none"> • Free • Single use (24 hours) |
| Standard | <ul style="list-style-type: none"> • Continuous monitoring of FlexPod configurations • Health dashboards to view FlexPod best practice compliance • Firmware interoperability for compute, network, storage, and hypervisor • Lifecycle management tools to identify changes and prevent configuration drift • Detailed inventory and system diagrams for advanced troubleshooting • Support provided directly by NetApp | Subscription-based license: <ul style="list-style-type: none"> • 12 months minimum • 60 months maximum |
| Premium | All functionality included in the Standard license, plus: <ul style="list-style-type: none"> • Reporting <p>Comprehensive, real-time reporting of FlexPod health, interoperability, and inventory</p> • Notification and alerting <p>Regular notifications of configuration health and changes in status</p> | Subscription-based license: <ul style="list-style-type: none"> • 12 months minimum • 60 months maximum |

Security

Converged Systems Advisor collects configuration data about your FlexPod converged infrastructure to help you validate and monitor the system. You might want to understand how the data is collected, how it is transferred to NetApp, and how it is kept secure and private.

How the data is collected

The Converged Systems Advisor agent requires credentials to access the devices in your FlexPod converged infrastructure. Read-only credentials are required for Cisco UCS and Nexus switches, while admin credentials are required for ONTAP. The credentials are encrypted and stored locally on the agent—they are not sent to the cloud-based portal.

After you provide the credentials, the agent collects *configuration* data from the devices. *Customer* data that resides on the devices is never accessed or transferred. A representative sample of the configuration data that the agent collects includes the following:

- Capacity
- CPU and memory
- Device connectivity
- Device names and IDs
- Device state
- Firmware versions
- IP addresses
- iSCSI targets
- Licenses
- MAC addresses
- Model numbers
- Serial numbers

How the data is transferred

After the agent discovers configuration data from your FlexPod converged infrastructure, it sends the data to the Converged Systems Advisor portal using HTTPS. The communication is encrypted using NetApp's TLS 1.2 certificate.

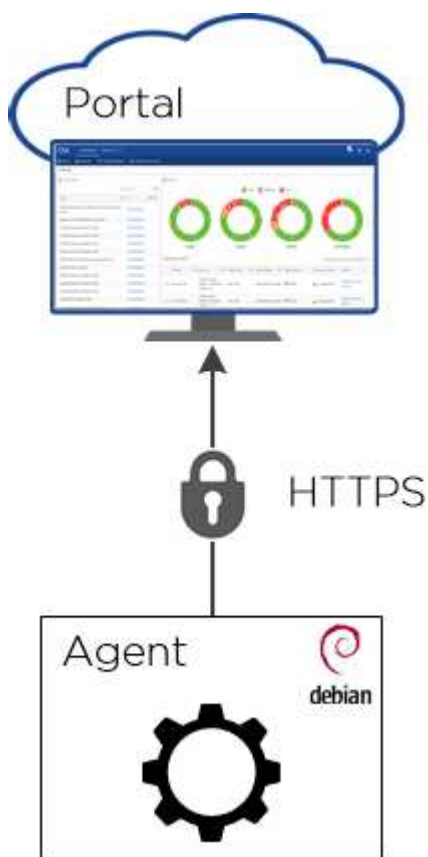

How the data is kept secure and private

The configuration data resides within the NetApp network and is managed by NetApp IT. The data is secured by a data access layer that requires positive identification of each user who requests access.

The user who deployed the agent can access the data from the Converged Systems Advisor portal by logging in with a NetApp Support Site account. This user has *owner* privileges to the converged infrastructure. The owner can share the converged infrastructure with other users by granting read-only, write, or owner privileges. Those users must also have a registered NetApp Support Site account to log in to the portal.

[Review the differences between read-only, write, and owner privileges.](#)

User roles

When you share a converged infrastructure with another user, you must provide read-only, write, or owner privileges.

The following table identifies the tasks that each user role can perform.

| Task | Read-only | Write | Owner |
|-----------------------------------|-----------|-------------------------------------|---|
| View a system | Yes | Yes | Yes |
| Update a system's name | No | Yes | Yes |
| Update support contract details | No | Yes | Yes |
| Edit the data collection interval | No | Yes | Yes |
| Request a new data collection | No | Yes | Yes |
| Share a system | No | Yes, with read-only or write access | Yes, with read-only, write, or owner access |
| Modify the components of a system | No | No | Yes |
| Delete a system | No | No | Yes |

Copyright information

Copyright © 2025 NetApp, Inc. All Rights Reserved. Printed in the U.S. No part of this document covered by copyright may be reproduced in any form or by any means—graphic, electronic, or mechanical, including photocopying, recording, taping, or storage in an electronic retrieval system—without prior written permission of the copyright owner.

Software derived from copyrighted NetApp material is subject to the following license and disclaimer:

THIS SOFTWARE IS PROVIDED BY NETAPP “AS IS” AND WITHOUT ANY EXPRESS OR IMPLIED WARRANTIES, INCLUDING, BUT NOT LIMITED TO, THE IMPLIED WARRANTIES OF MERCHANTABILITY AND FITNESS FOR A PARTICULAR PURPOSE, WHICH ARE HEREBY DISCLAIMED. IN NO EVENT SHALL NETAPP BE LIABLE FOR ANY DIRECT, INDIRECT, INCIDENTAL, SPECIAL, EXEMPLARY, OR CONSEQUENTIAL DAMAGES (INCLUDING, BUT NOT LIMITED TO, PROCUREMENT OF SUBSTITUTE GOODS OR SERVICES; LOSS OF USE, DATA, OR PROFITS; OR BUSINESS INTERRUPTION) HOWEVER CAUSED AND ON ANY THEORY OF LIABILITY, WHETHER IN CONTRACT, STRICT LIABILITY, OR TORT (INCLUDING NEGLIGENCE OR OTHERWISE) ARISING IN ANY WAY OUT OF THE USE OF THIS SOFTWARE, EVEN IF ADVISED OF THE POSSIBILITY OF SUCH DAMAGE.

NetApp reserves the right to change any products described herein at any time, and without notice. NetApp assumes no responsibility or liability arising from the use of products described herein, except as expressly agreed to in writing by NetApp. The use or purchase of this product does not convey a license under any patent rights, trademark rights, or any other intellectual property rights of NetApp.

The product described in this manual may be protected by one or more U.S. patents, foreign patents, or pending applications.

LIMITED RIGHTS LEGEND: Use, duplication, or disclosure by the government is subject to restrictions as set forth in subparagraph (b)(3) of the Rights in Technical Data -Noncommercial Items at DFARS 252.227-7013 (FEB 2014) and FAR 52.227-19 (DEC 2007).

Data contained herein pertains to a commercial product and/or commercial service (as defined in FAR 2.101) and is proprietary to NetApp, Inc. All NetApp technical data and computer software provided under this Agreement is commercial in nature and developed solely at private expense. The U.S. Government has a non-exclusive, non-transferrable, nonsublicensable, worldwide, limited irrevocable license to use the Data only in connection with and in support of the U.S. Government contract under which the Data was delivered. Except as provided herein, the Data may not be used, disclosed, reproduced, modified, performed, or displayed without the prior written approval of NetApp, Inc. United States Government license rights for the Department of Defense are limited to those rights identified in DFARS clause 252.227-7015(b) (FEB 2014).

Trademark information

NETAPP, the NETAPP logo, and the marks listed at <http://www.netapp.com/TM> are trademarks of NetApp, Inc. Other company and product names may be trademarks of their respective owners.