



Create a disk from a snapshot

NetApp Keystone

Ciaran McNamara, David Peterson
October 29, 2020

Table of Contents

Create a disk from a snapshot 1

Create a disk from a snapshot

This section describes how to create a new disk from a snapshot. The process can use an existing snapshot or can create an immediate adhoc snapshot that will be used for the cloning operation. For information about:

- How to create a new disk directly (see [Create a new disk](#))
- Snapshots (see [Create a disk from a snapshot](#))

Steps

1. Display the Disks list ([View disks](#)).
2. To create the disk from a snapshot, you can either:
 - a. Click **Create Disk**, select Clone from snapshot, and then go to step 3; or

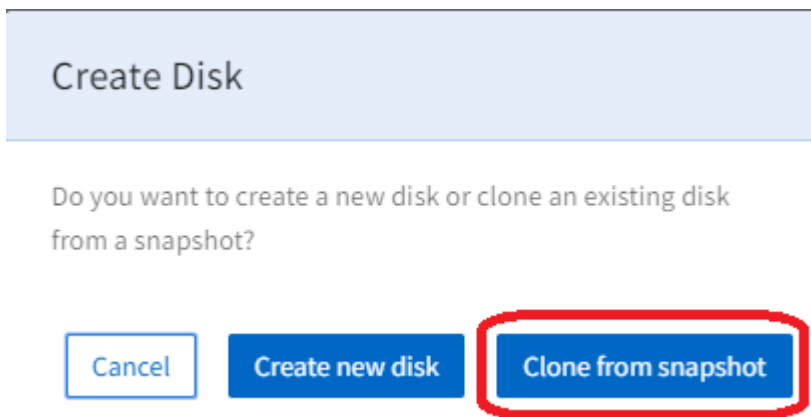

- b. Locate the disk in the list, click the Create disk from the snapshot icon and then go to step 4.
3. Select the disk containing the snapshot to clone by selecting checkbox in the Select column, then click **Next**.



Filter the list by region, zone, and subtenant to quickly locate the disk in the list.

4. To use an existing snapshot, select the snapshot to clone; you can filter the list by schedule type or search for the snapshot by name (partial matches accepted).



To create a new snapshot, do not select a snapshot.

5. Click **Next**.
6. If the disk has no snapshot, a snapshot will be created as you proceed. Enter the new disk name and disk path and select an operating system type.
7. Review the other selections that are inherited from the snapshot and select or amend as required. For field descriptions, see [Create a new disk](#).
8. Click **Create**. This creates a job to create the clone with the specified settings.

After you finish

Create disk is run as an [asynchronous job](#). You can:

- Check the status of the job in the jobs list.
- After the job is finished, check the status of the disk in the Disks list.

Copyright Information

Copyright © 2021 NetApp, Inc. All rights reserved. Printed in the U.S. No part of this document covered by copyright may be reproduced in any form or by any means-graphic, electronic, or mechanical, including photocopying, recording, taping, or storage in an electronic retrieval system-without prior written permission of the copyright owner.

Software derived from copyrighted NetApp material is subject to the following license and disclaimer:

THIS SOFTWARE IS PROVIDED BY NETAPP "AS IS" AND WITHOUT ANY EXPRESS OR IMPLIED WARRANTIES, INCLUDING, BUT NOT LIMITED TO, THE IMPLIED WARRANTIES OF MERCHANTABILITY AND FITNESS FOR A PARTICULAR PURPOSE, WHICH ARE HEREBY DISCLAIMED. IN NO EVENT SHALL NETAPP BE LIABLE FOR ANY DIRECT, INDIRECT, INCIDENTAL, SPECIAL, EXEMPLARY, OR CONSEQUENTIAL DAMAGES (INCLUDING, BUT NOT LIMITED TO, PROCUREMENT OF SUBSTITUTE GOODS OR SERVICES; LOSS OF USE, DATA, OR PROFITS; OR BUSINESS INTERRUPTION) HOWEVER CAUSED AND ON ANY THEORY OF LIABILITY, WHETHER IN CONTRACT, STRICT LIABILITY, OR TORT (INCLUDING NEGLIGENCE OR OTHERWISE) ARISING IN ANY WAY OUT OF THE USE OF THIS SOFTWARE, EVEN IF ADVISED OF THE POSSIBILITY OF SUCH DAMAGE.

NetApp reserves the right to change any products described herein at any time, and without notice. NetApp assumes no responsibility or liability arising from the use of products described herein, except as expressly agreed to in writing by NetApp. The use or purchase of this product does not convey a license under any patent rights, trademark rights, or any other intellectual property rights of NetApp.

The product described in this manual may be protected by one or more U.S. patents, foreign patents, or pending applications.

RESTRICTED RIGHTS LEGEND: Use, duplication, or disclosure by the government is subject to restrictions as set forth in subparagraph (c)(1)(ii) of the Rights in Technical Data and Computer Software clause at DFARS 252.277-7103 (October 1988) and FAR 52-227-19 (June 1987).

Trademark Information

NETAPP, the NETAPP logo, and the marks listed at <http://www.netapp.com/TM> are trademarks of NetApp, Inc. Other company and product names may be trademarks of their respective owners.