



Boot media

Install and maintain

NetApp
February 02, 2026

Table of Contents

- Boot media 1
 - Overview of boot media replacement - FAS500f 1
 - Check encryption key support and status - FAS500f 1
 - Step 1: Check NVE support and download the correct ONTAP image 1
 - Step 2: Verify key manager status and back up configuration 1
 - Shut down the controller - FAS500f 4
 - Option 1: Most configurations 4
 - Option 2: Controller is in a MetroCluster 5
 - Replace the boot media - FAS500f 6
 - Step 1: Remove the controller module 6
 - Step 2: Replace the boot media 8
 - Step 3: Transfer the boot image to the boot media 9
 - Boot the recovery image - FAS500f 12
 - Restore encryption - FAS500f 15
 - Return the failed part to NetApp - FAS500f 25

Boot media

Overview of boot media replacement - FAS500f

The boot media stores a primary and secondary set of system (boot image) files that the system uses when it boots.

You must have a USB flash drive, formatted to MBR/FAT32, with the appropriate amount of storage to hold the `image_XXX.tgz` file.

- You must replace the failed component with a replacement FRU component you received from your provider.
- It is important that you apply the commands in these steps on the correct controller:
 - The *impaired* controller is the controller on which you are performing maintenance.
 - The *healthy* controller is the HA partner of the impaired controller.

Check encryption key support and status - FAS500f

To ensure data security on your storage system, you need to verify the encryption key support and status on your boot media. Check if your ONTAP version supports NetApp Volume Encryption (NVE), and before you shut down the controller check if the key manager is active.

Step 1: Check NVE support and download the correct ONTAP image

Determine whether your ONTAP version supports NetApp Volume Encryption (NVE) so you can download the correct ONTAP image for the boot media replacement.

Steps

1. Check if your ONTAP version supports encryption:

```
version -v
```

If the output includes `1Ono-DARE`, NVE is not supported on your cluster version.

2. Download the appropriate ONTAP image based on NVE support:
 - If NVE is supported: Download the ONTAP image with NetApp Volume Encryption
 - If NVE is not supported: Download the ONTAP image without NetApp Volume Encryption



Download the ONTAP image from the NetApp Support Site to your HTTP or FTP server or a local folder. You will need this image file during the boot media replacement procedure.

Step 2: Verify key manager status and back up configuration

Before shutting down the impaired controller, verify the key manager configuration and back up the necessary information.

Steps

1. Determine which key manager is enabled on your system:

ONTAP version	Run this command
ONTAP 9.14.1 or later	<pre>security key-manager keystore show</pre> <ul style="list-style-type: none">• If EKM is enabled, <code>EKM</code> is listed in the command output.• If OKM is enabled, <code>OKM</code> is listed in the command output.• If no key manager is enabled, <code>No key manager keystores configured</code> is listed in the command output.
ONTAP 9.13.1 or earlier	<pre>security key-manager show-key-store</pre> <ul style="list-style-type: none">• If EKM is enabled, <code>external</code> is listed in the command output.• If OKM is enabled, <code>onboard</code> is listed in the command output.• If no key manager is enabled, <code>No key managers configured</code> is listed in the command output.

2. Depending on whether a key manager is configured on your system, do one of the following:

If no key manager is configured:

You can safely shut down the impaired controller and proceed to the shutdown procedure.

If a key manager is configured (EKM or OKM):

- a. Enter the following query command to display the status of the authentication keys in your key manager:

```
security key-manager key query
```

- b. Review the output and check the value in the `Restored` column. This column indicates whether the authentication keys for your key manager (either EKM or OKM) have been successfully restored.

3. Complete the appropriate procedure based on your key manager type:

External Key Manager (EKM)

Complete these steps based on the value in the `Restored` column.

If all keys show `true` in the `Restored` column:

You can safely shut down the impaired controller and proceed to the shutdown procedure.

If any keys show a value other than `true` in the `Restored` column:

- a. Restore the external key management authentication keys to all nodes in the cluster:

```
security key-manager external restore
```

If the command fails, contact NetApp Support.

- b. Verify that all authentication keys are restored:

```
security key-manager key query
```

Confirm that the `Restored` column displays `true` for all authentication keys.

- c. If all keys are restored, you can safely shut down the impaired controller and proceed to the shutdown procedure.

Onboard Key Manager (OKM)

Complete these steps based on the value in the `Restored` column.

If all keys show `true` in the `Restored` column:

- a. Back up the OKM information:

- i. Switch to advanced privilege mode:

```
set -priv advanced
```

Enter `y` when prompted to continue.

- ii. Display the key management backup information:

```
security key-manager onboard show-backup
```

- iii. Copy the backup information to a separate file or your log file.

You will need this backup information if you need to manually recover OKM during the replacement procedure.

- iv. Return to admin mode:

```
set -priv admin
```

- b. You can safely shut down the impaired controller and proceed to the shutdown procedure.

If any keys show a value other than `true` in the `Restored` column:

a. Synchronize the onboard key manager:

```
security key-manager onboard sync
```

Enter the 32-character alphanumeric onboard key management passphrase when prompted.



This is the cluster-wide passphrase you created when you initially configured the Onboard Key Manager. If you do not have this passphrase, contact NetApp Support.

b. Verify all authentication keys are restored:

```
security key-manager key query
```

Confirm that the `Restored` column displays `true` for all authentication keys and the `Key Manager type` shows `onboard`.

c. Back up the OKM information:

i. Switch to advanced privilege mode:

```
set -priv advanced
```

Enter `y` when prompted to continue.

ii. Display the key management backup information:

```
security key-manager onboard show-backup
```

iii. Copy the backup information to a separate file or your log file.

You will need this backup information if you need to manually recover OKM during the replacement procedure.

iv. Return to admin mode:

```
set -priv admin
```

d. You can safely shut down the impaired controller and proceed to the shutdown procedure.

Shut down the controller - FAS500f

After completing the NVE or NSE tasks, you need to complete the shutdown of the impaired controller. Shut down or take over the impaired controller using the appropriate procedure for your configuration.

Option 1: Most configurations

After completing the NVE or NSE tasks, you need to complete the shutdown of the impaired controller.

Steps

- a. Take the impaired controller to the LOADER prompt:

If the impaired controller displays...	Then...
The LOADER prompt	Go to Remove controller module.
Waiting for giveback...	Press Ctrl-C, and then respond <code>y</code> when prompted.
System prompt or password prompt (enter system password)	Take over or halt the impaired controller from the healthy controller: <code>storage failover takeover -ofnode impaired_node_name</code> When the impaired controller shows Waiting for giveback..., press Ctrl-C, and then respond <code>y</code> .

- b. From the LOADER prompt, enter: `printenv` to capture all boot environmental variables. Save the output to your log file.



This command may not work if the boot device is corrupted or non-functional.

Option 2: Controller is in a MetroCluster



Do not use this procedure if your system is in a two-node MetroCluster configuration.

To shut down the impaired controller, you must determine the status of the controller and, if necessary, take over the controller so that the healthy controller continues to serve data from the impaired controller storage.

- If you have a cluster with more than two nodes, it must be in quorum. If the cluster is not in quorum or a healthy controller shows false for eligibility and health, you must correct the issue before shutting down the impaired controller; see [Synchronize a node with the cluster](#).
- If you have a MetroCluster configuration, you must have confirmed that the MetroCluster Configuration State is configured and that the nodes are in an enabled and normal state (`metrocluster node show`).

Steps

1. If AutoSupport is enabled, suppress automatic case creation by invoking an AutoSupport message:

```
system node autosupport invoke -node * -type all -message  
MAINT=number_of_hours_downh
```

The following AutoSupport message suppresses automatic case creation for two hours: `cluster1:>`

```
system node autosupport invoke -node * -type all -message MAINT=2h
```

2. Disable automatic giveback from the console of the healthy controller: `storage failover modify -node local -auto-giveback false`
3. Take the impaired controller to the LOADER prompt:

If the impaired controller is displaying...	Then...
The LOADER prompt	Go to the next step.
Waiting for giveback...	Press Ctrl-C, and then respond <code>y</code> when prompted.
System prompt or password prompt (enter system password)	<p>Take over or halt the impaired controller from the healthy controller:</p> <pre>storage failover takeover -ofnode impaired_node_name</pre> <p>When the impaired controller shows Waiting for giveback..., press Ctrl-C, and then respond <code>y</code>.</p>

Replace the boot media - FAS500f

To replace the boot media, you must remove the impaired controller module, install the replacement boot media, and transfer the boot image to a USB flash drive.

Step 1: Remove the controller module

You must remove the controller module from the chassis when you replace a component inside the controller module.

Make sure that you label the cables so that you know where they came from.

1. If you are not already grounded, properly ground yourself.
2. Unplug the controller module power supplies from the source.
3. Release the power cable retainers, and then unplug the cables from the power supplies.
4. Insert your forefinger into the latching mechanism on either side of the controller module, press the lever with your thumb, and gently pull the controller a few inches out of the chassis.



If you have difficulty removing the controller module, place your index fingers through the finger holes from the inside (by crossing your arms).

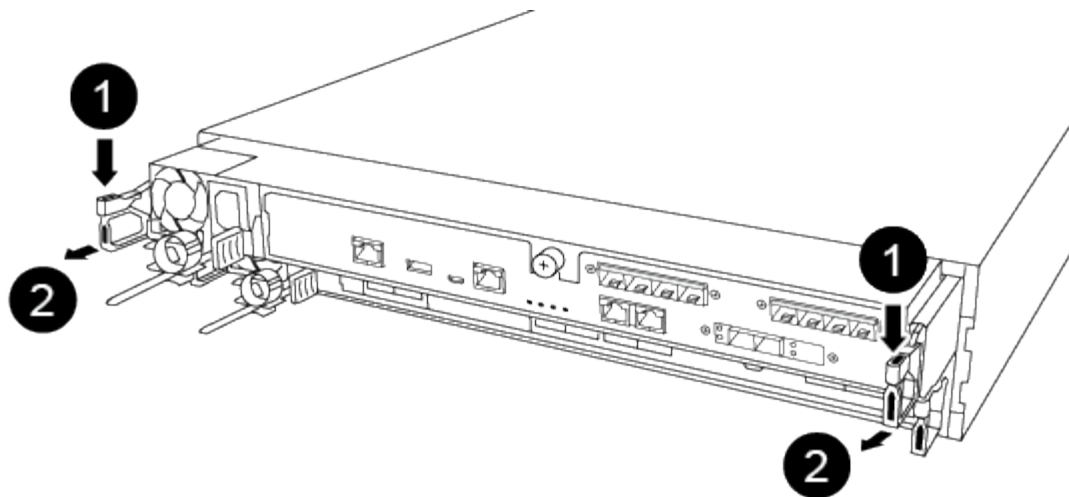

1	Lever
2	Latching mechanism

5. Using both hands, grasp the controller module sides and gently pull it out of the chassis and set it on a flat, stable surface.
6. Turn the thumbscrew on the front of the controller module anti-clockwise and open the controller module cover.

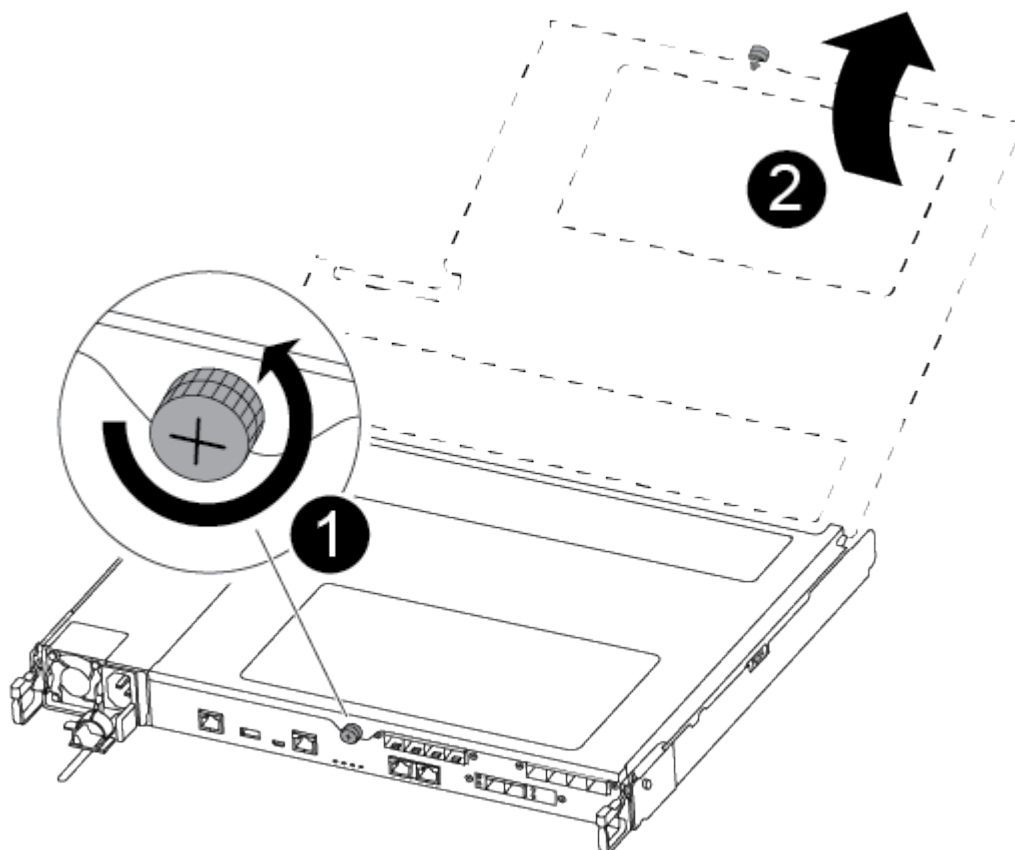

1	Thumbscrew
2	Controller module cover.

7. Lift out the air duct cover.

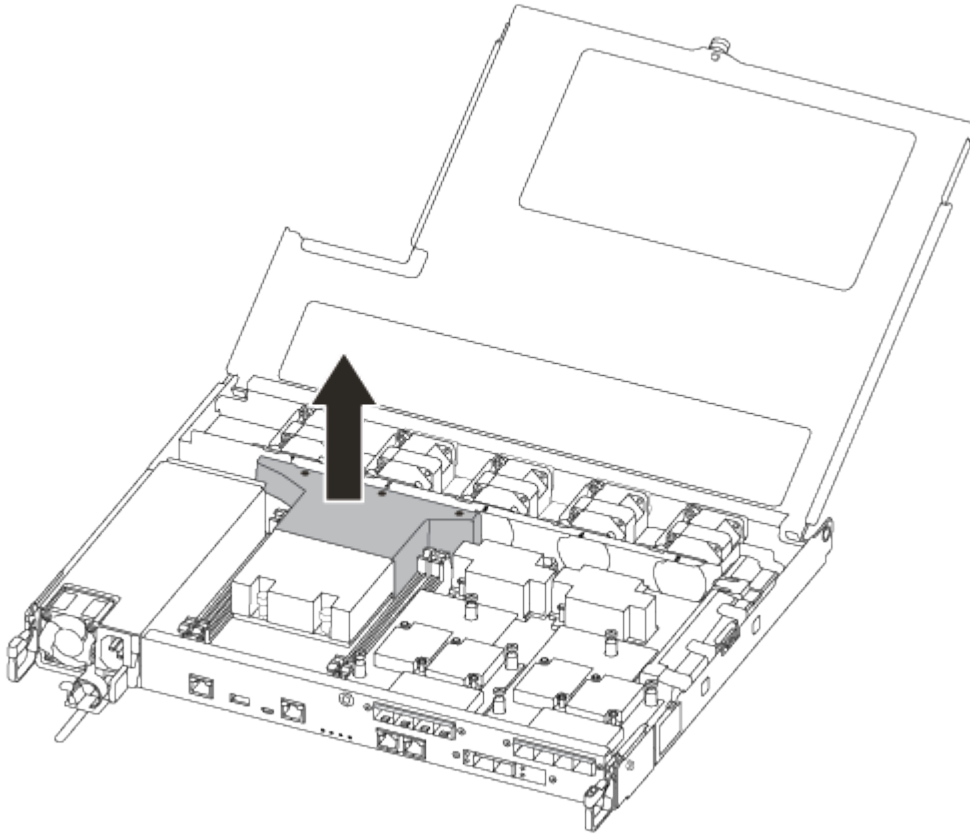

Step 2: Replace the boot media

You locate the failed boot media in the controller module by removing the air duct on the controller module before you can replace the boot media.

You need a #1 magnetic Phillips head screwdriver to remove the screw that holds the boot media in place. Due to the space constraints within the controller module, you should also have a magnet to transfer the screw on to so that you do not lose it.

You can use the following video or the tabulated steps to replace the boot media:

[Animation - Replace the boot media](#)

1. Locate and replace the impaired boot media from the controller module.

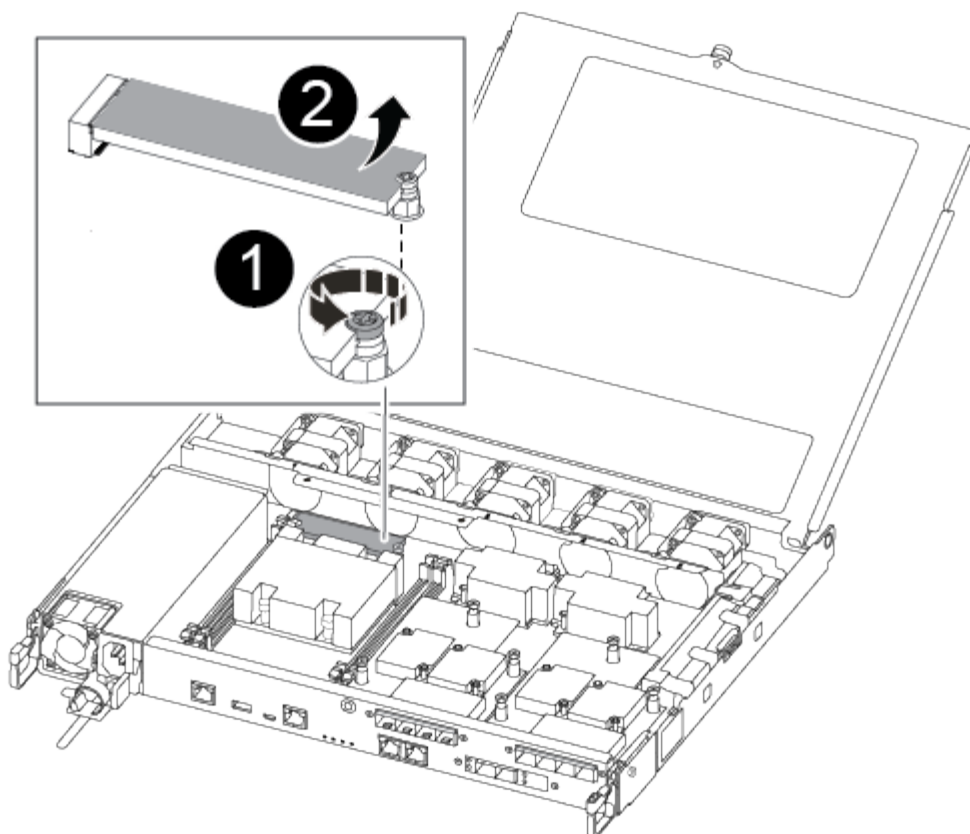

1	Remove the screw securing the boot media to the motherboard in the controller module.
2	Lift the boot media out of the controller module.

- a. Using the #1 magnetic screwdriver, remove the screw from the impaired boot media, and set it aside safely on the magnet.
- b. Gently lift the impaired boot media directly out of the socket and set it aside.
- c. Remove the replacement boot media from the antistatic shipping bag and align it into place on the controller module.
- d. Using the #1 magnetic screwdriver, insert and tighten the screw on the boot media.



Do not apply force when tightening the screw on the boot media; you might crack it.

Step 3: Transfer the boot image to the boot media

The replacement boot media that you installed is without a boot image so you need to transfer a boot image using a USB flash drive.

- You must have a USB flash drive, formatted to MBR/FAT32, with at least 4GB capacity
- A copy of the same image version of ONTAP as what the impaired controller was running. You can download the appropriate image from the **Downloads** section on the NetApp Support Site

- If NVE is enabled, download the image with NetApp Volume Encryption, as indicated in the download button.
- If NVE is not enabled, download the image without NetApp Volume Encryption, as indicated in the download button.
- If your system is an HA pair, you must have a network connection.
- If your system is a stand-alone system you do not need a network connection, but you must perform an additional reboot when restoring the var file system.

Steps

1. Download and copy the appropriate service image from the NetApp Support Site to the USB flash drive.
2. Download the service image to your work space on your laptop.
3. Unzip the service image.



If you are extracting the contents using Windows, do not use WinZip to extract the netboot image. Use another extraction tool, such as 7-Zip or WinRAR.

There are two folders in the unzipped service image file:

- `boot`
- `efi`

4. Copy the `efi` folder to the top directory on the USB flash drive.

The USB flash drive should have the `efi` folder and the same Service Image (BIOS) version of what the impaired controller is running.

5. Remove the USB flash drive from your laptop.
6. If you have not already done so, install the air duct.

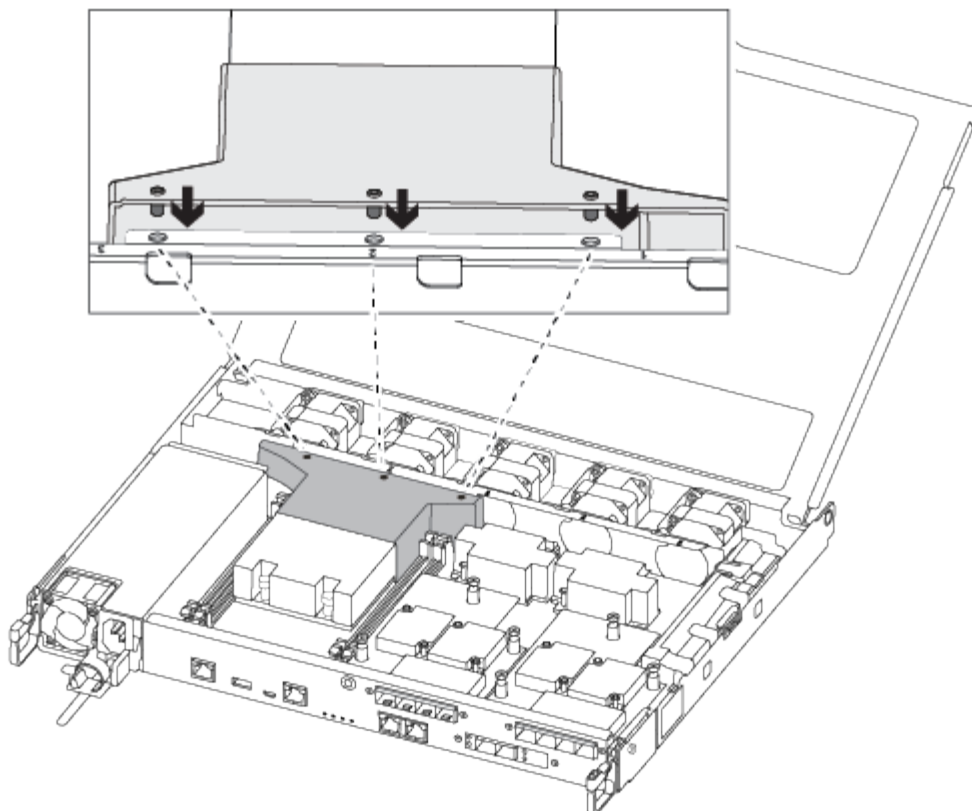

7. Close the controller module cover and tighten the thumbscrew.

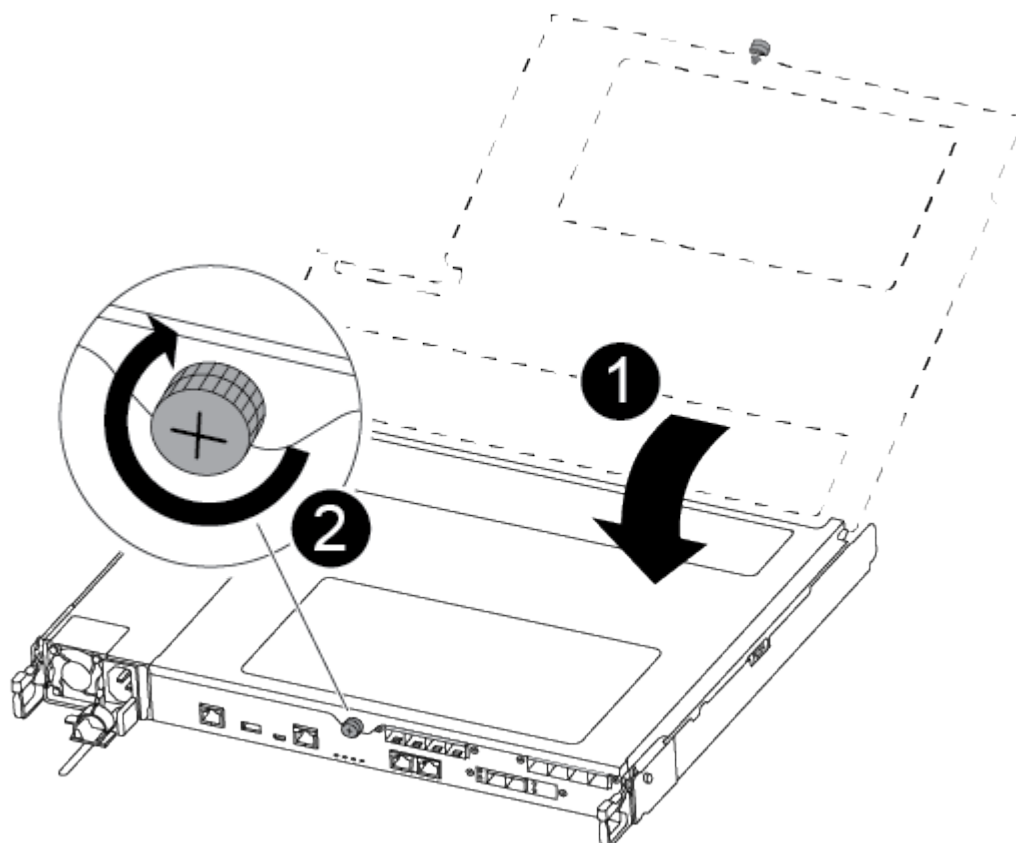

1	Controller module cover
2	Thumbscrew

8. Align the end of the controller module with the opening in the chassis, and then gently push the controller module halfway into the system.
9. Plug the power cable into the power supply and reinstall the power cable retainer.
10. Insert the USB flash drive into the USB slot on the controller module.

Make sure that you install the USB flash drive in the slot labeled for USB devices, and not in the USB console port.

11. Push the controller module all the way into the chassis:
12. Place your index fingers through the finger holes from the inside of the latching mechanism.
13. Press your thumbs down on the orange tabs on top of the latching mechanism and gently push the controller module over the stop.
14. Release your thumbs from the top of the latching mechanisms and continue pushing until the latching mechanisms snap into place.

The controller module begins to boot as soon as it is fully seated in the chassis. Be prepared to interrupt the boot process.

The controller module should be fully inserted and flush with the edges of the chassis.

Boot the recovery image - FAS500f

You must boot the ONTAP image from the USB drive, restore the file system, and verify the environmental variables.

Steps

1. From the LOADER prompt, boot the recovery image from the USB flash drive:

```
boot_recovery
```

The image is downloaded from the USB flash drive.

2. When prompted, either enter the name of the image or accept the default image displayed inside the brackets on your screen.
3. Restore the var file system:

If your system has...	Then...
A network connection	<ul style="list-style-type: none"> a. Press <code>y</code> when prompted to restore the backup configuration. b. Set the healthy controller to advanced privilege level: <code>set -privilege advanced</code> c. Run the restore backup command: <code>system node restore-backup -node local -target-address <i>impaired_node_IP_address</i></code> d. Return the controller to admin level: <code>set -privilege admin</code> e. Press <code>y</code> when prompted to use the restored configuration. f. Press <code>y</code> when prompted to reboot the controller.
No network connection	<ul style="list-style-type: none"> a. Press <code>n</code> when prompted to restore the backup configuration. b. Reboot the system when prompted by the system. c. Select the Update flash from backup config (sync flash) option from the displayed menu. <p>If you are prompted to continue with the update, press <code>y</code>.</p>

If your system has...	Then...
No network connection and is in a MetroCluster IP configuration	<p>a. Press n when prompted to restore the backup configuration.</p> <p>b. Reboot the system when prompted by the system.</p> <p>c. Wait for the iSCSI storage connections to connect.</p> <p>You can proceed after you see the following messages:</p> <div data-bbox="672 394 1489 1257" style="border: 1px solid #ccc; padding: 10px; margin: 10px 0;"> <pre> date-and-time [node- name:iscsi.session.stateChanged:notice]: iSCSI session state is changed to Connected for the target iSCSI-target (type: dr_auxiliary, address: ip-address). date-and-time [node- name:iscsi.session.stateChanged:notice]: iSCSI session state is changed to Connected for the target iSCSI-target (type: dr_partner, address: ip-address). date-and-time [node- name:iscsi.session.stateChanged:notice]: iSCSI session state is changed to Connected for the target iSCSI-target (type: dr_auxiliary, address: ip-address). date-and-time [node- name:iscsi.session.stateChanged:notice]: iSCSI session state is changed to Connected for the target iSCSI-target (type: dr_partner, address: ip-address).</pre> </div> <p>d. Select the Update flash from backup config (sync flash) option from the displayed menu.</p> <p>If you are prompted to continue with the update, press y.</p>

4. Ensure that the environmental variables are set as expected:
 - a. Take the controller to the **LOADER** prompt.
 - b. Check the environment variable settings with the `printenv` command.
 - c. If an environment variable is not set as expected, modify it with the `setenv environment-variable-name changed-value` command.
 - d. Save your changes using the `savenv` command.
5. The next depends on your system configuration:
 - If your system has onboard keymanager, NSE or NVE configured, go to [Restore OKM, NSE, and NVE as needed](#)

- If your system does not have onboard keymanager, NSE or NVE configured, complete the steps in this section.

6. From the LOADER prompt, enter the `boot_ontap` command.

If you see...	Then...
The login prompt	Go to the next Step.
Waiting for giveback...	a. Log into the partner controller. b. Confirm the target controller is ready for giveback with the <code>storage failover show</code> command.

7. Connect the console cable to the partner controller.

8. Give back the controller using the `storage failover giveback -fromnode local` command.

9. At the cluster prompt, check the logical interfaces with the `net int -is-home false` command.

If any interfaces are listed as "false", revert those interfaces back to their home port using the `net int revert` command.

10. Move the console cable to the repaired controller and run the `version -v` command to check the ONTAP versions.

11. Restore automatic giveback if you disabled it by using the `storage failover modify -node local -auto-giveback true` command.

Restore encryption - FAS500f

Restore encryption on the replacement boot media.

Complete the appropriate steps to restore encryption on your system based on your key manager type. If you are unsure which key manager your system uses, check the settings you captured at the beginning of the boot media replacement procedure.

Onboard Key Manager (OKM)

Restore the Onboard Key Manager (OKM) configuration from the ONTAP boot menu.

Before you begin

Ensure you have the following information available:

- Cluster-wide passphrase entered while [enabling onboard key management](#)
- [Backup information for the Onboard Key Manager](#)
- Verification that you have the correct passphrase and backup data using the [How to verify onboard key management backup and cluster-wide passphrase](#) procedure

Steps

On the impaired controller:

1. Connect the console cable to the impaired controller.
2. From the ONTAP boot menu, select the appropriate option:

ONTAP version	Select this option
ONTAP 9.8 or later	<p>Select option 10.</p> <p>Show example boot menu</p> <div><p>Please choose one of the following:</p><ul style="list-style-type: none">(1) Normal Boot.(2) Boot without /etc/rc.(3) Change password.(4) Clean configuration and initialize all disks.(5) Maintenance mode boot.(6) Update flash from backup config.(7) Install new software first.(8) Reboot node.(9) Configure Advanced Drive Partitioning.(10) Set Onboard Key Manager recovery secrets.(11) Configure node for external key management.<p>Selection (1-11)? 10</p></div>

ONTAP version	Select this option
ONTAP 9.7 and earlier	<p>Select the hidden option <code>recover_onboard_keymanager</code></p> <p>Show example boot menu</p> <div> <p>Please choose one of the following:</p> <ul style="list-style-type: none"> (1) Normal Boot. (2) Boot without <code>/etc/rc</code>. (3) Change password. (4) Clean configuration and initialize all disks. (5) Maintenance mode boot. (6) Update flash from backup config. (7) Install new software first. (8) Reboot node. (9) Configure Advanced Drive Partitioning. <p>Selection (1-19)?</p> <p><code>recover_onboard_keymanager</code></p> </div>

- Confirm that you want to continue the recovery process when prompted:

Show example prompt

```
This option must be used only in disaster recovery procedures. Are you
sure? (y or n):
```

- Enter the cluster-wide passphrase twice.

While entering the passphrase, the console does not show any input.

Show example prompt

```
Enter the passphrase for onboard key management:

Enter the passphrase again to confirm:
```

- Enter the backup information:
 - Paste the entire content from the BEGIN BACKUP line through the END BACKUP line, including the dashes.

Show example prompt

Enter the backup data:

[illegible]

```
AAAAAAAAAAAAAAAAAAAAAAAAAAAAAAAAAAAAAAAAAAAAAAAAAAAAAAAAAAAA
AA
AAAAAAAAAAAAAAAAAAAAAAAAAAAAAAAAAAAAAAAAAAAAAAAAAAAAAAAAAAAA
AA
AAAAAAAAAAAAAAAAAAAAAAAAAAAAAAAAAAAAAAAAAAAAAAAAAAAAAAAAAAAA
AA
01234567890123456789012345678901234567890123456789012345678901
23
12345678901234567890123456789012345678901234567890123456789012
34
23456789012345678901234567890123456789012345678901234567890123
45
AAAAAAAAAAAAAAAAAAAAAAAAAAAAAAAAAAAAAAAAAAAAAAAAAAAAAAAAAAAA
AA
AAAAAAAAAAAAAAAAAAAAAAAAAAAAAAAAAAAAAAAAAAAAAAAAAAAAAAAAAAAA
AA
AAAAAAAAAAAAAAAAAAAAAAAAAAAAAAAAAAAAAAAAAAAAAAAAAAAAAAAAAAAA
AA

-----END
BACKUP-----
```

b. Press Enter twice at the end of the input.

The recovery process completes and displays the following message:

Successfully recovered keymanager secrets.

Show example prompt

```
Trying to recover keymanager secrets....
Setting recovery material for the onboard key manager
Recovery secrets set successfully
Trying to delete any existing km_onboard.wkeydb file.

Successfully recovered keymanager secrets.

*****
*****
* Select option "(1) Normal Boot." to complete recovery
process.
*
* Run the "security key-manager onboard sync" command to
synchronize the key database after the node reboots.
*****
*****
```



Do not proceed if the displayed output is anything other than Successfully recovered keymanager secrets. Perform troubleshooting to correct the error.

6. Select option 1 from the boot menu to continue booting into ONTAP.

Show example prompt

```
*****
*****
* Select option "(1) Normal Boot." to complete the recovery
process.
*
*****
*****

(1) Normal Boot.
(2) Boot without /etc/rc.
(3) Change password.
(4) Clean configuration and initialize all disks.
(5) Maintenance mode boot.
(6) Update flash from backup config.
(7) Install new software first.
(8) Reboot node.
(9) Configure Advanced Drive Partitioning.
(10) Set Onboard Key Manager recovery secrets.
(11) Configure node for external key management.
Selection (1-11)? 1
```

7. Confirm that the controller's console displays the following message:

```
Waiting for giveback...(Press Ctrl-C to abort wait)
```

On the partner controller:

8. Giveback the impaired controller:

```
storage failover giveback -fromnode local -only-cfo-aggregates true
```

On the impaired controller:

9. After booting with only the CFO aggregate, synchronize the key manager:

```
security key-manager onboard sync
```

10. Enter the cluster-wide passphrase for the Onboard Key Manager when prompted.

Show example prompt

Enter the cluster-wide passphrase for the Onboard Key Manager:

All offline encrypted volumes will be brought online and the corresponding volume encryption keys (VEKs) will be restored automatically within 10 minutes. If any offline encrypted volumes are not brought online automatically, they can be brought online manually using the "volume online -vserver <vserver> -volume <volume_name>" command.



If the sync is successful, the cluster prompt is returned with no additional messages. If the sync fails, an error message appears before returning to the cluster prompt. Do not continue until the error is corrected and the sync runs successfully.

11. Verify that all keys are synced:

```
security key-manager key query -restored false
```

The command should return no results. If any results appear, repeat the sync command until no results are returned.

On the partner controller:

12. Giveback the impaired controller:

```
storage failover giveback -fromnode local
```

13. Restore automatic giveback if you disabled it:

```
storage failover modify -node local -auto-giveback true
```

14. If AutoSupport is enabled, restore automatic case creation:

```
system node autosupport invoke -node * -type all -message MAINT=END
```

External Key Manager (EKM)

Restore the External Key Manager configuration from the ONTAP boot menu.

Before you begin

Gather the following files from another cluster node or from your backup:

- /cfcard/knip/servers.cfg file or the KMIP server address and port
- /cfcard/knip/certs/client.crt file (client certificate)
- /cfcard/knip/certs/client.key file (client key)
- /cfcard/knip/certs/CA.pem file (KMIP server CA certificates)

Steps

On the impaired controller:

1. Connect the console cable to the impaired controller.
2. Select option 11 from the ONTAP boot menu.

Show example boot menu

```
(1)  Normal Boot.
(2)  Boot without /etc/rc.
(3)  Change password.
(4)  Clean configuration and initialize all disks.
(5)  Maintenance mode boot.
(6)  Update flash from backup config.
(7)  Install new software first.
(8)  Reboot node.
(9)  Configure Advanced Drive Partitioning.
(10) Set Onboard Key Manager recovery secrets.
(11) Configure node for external key management.
Selection (1-11)? 11
```

3. Confirm you have gathered the required information when prompted:

Show example prompt

```
Do you have a copy of the /cfcard/kmip/certs/client.crt file?
{y/n}
Do you have a copy of the /cfcard/kmip/certs/client.key file?
{y/n}
Do you have a copy of the /cfcard/kmip/certs/CA.pem file? {y/n}
Do you have a copy of the /cfcard/kmip/servers.cfg file? {y/n}
```

4. Enter the client and server information when prompted:
 - a. Enter the client certificate (client.crt) file contents, including the BEGIN and END lines.
 - b. Enter the client key (client.key) file contents, including the BEGIN and END lines.
 - c. Enter the KMIP server CA(s) (CA.pem) file contents, including the BEGIN and END lines.
 - d. Enter the KMIP server IP address.
 - e. Enter the KMIP server port (press Enter to use the default port 5696).

Show example

```
Enter the client certificate (client.crt) file contents:
-----BEGIN CERTIFICATE-----
<certificate_value>
-----END CERTIFICATE-----

Enter the client key (client.key) file contents:
-----BEGIN RSA PRIVATE KEY-----
<key_value>
-----END RSA PRIVATE KEY-----

Enter the KMIP server CA(s) (CA.pem) file contents:
-----BEGIN CERTIFICATE-----
<certificate_value>
-----END CERTIFICATE-----

Enter the IP address for the KMIP server: 10.10.10.10
Enter the port for the KMIP server [5696]:

System is ready to utilize external key manager(s).
Trying to recover keys from key servers....
kmip_init: configuring ports
Running command '/sbin/ifconfig e0M'
..
..
kmip_init: cmd: ReleaseExtraBSDPort e0M
```

The recovery process completes and displays the following message:

Successfully recovered keymanager secrets.

Show example

```
System is ready to utilize external key manager(s).
Trying to recover keys from key servers....
Performing initialization of OpenSSL
Successfully recovered keymanager secrets.
```

5. Select option 1 from the boot menu to continue booting into ONTAP.

Show example prompt

```
*****
*****
* Select option "(1) Normal Boot." to complete the recovery
process.
*
*****
*****

(1) Normal Boot.
(2) Boot without /etc/rc.
(3) Change password.
(4) Clean configuration and initialize all disks.
(5) Maintenance mode boot.
(6) Update flash from backup config.
(7) Install new software first.
(8) Reboot node.
(9) Configure Advanced Drive Partitioning.
(10) Set Onboard Key Manager recovery secrets.
(11) Configure node for external key management.
Selection (1-11)? 1
```

6. Restore automatic giveback if you disabled it:

```
storage failover modify -node local -auto-giveback true
```

7. If AutoSupport is enabled, restore automatic case creation:

```
system node autosupport invoke -node * -type all -message MAINT=END
```

Return the failed part to NetApp - FAS500f

Return the failed part to NetApp, as described in the RMA instructions shipped with the kit. See the [Part Return and Replacements](#) page for further information.

Copyright information

Copyright © 2026 NetApp, Inc. All Rights Reserved. Printed in the U.S. No part of this document covered by copyright may be reproduced in any form or by any means—graphic, electronic, or mechanical, including photocopying, recording, taping, or storage in an electronic retrieval system—without prior written permission of the copyright owner.

Software derived from copyrighted NetApp material is subject to the following license and disclaimer:

THIS SOFTWARE IS PROVIDED BY NETAPP “AS IS” AND WITHOUT ANY EXPRESS OR IMPLIED WARRANTIES, INCLUDING, BUT NOT LIMITED TO, THE IMPLIED WARRANTIES OF MERCHANTABILITY AND FITNESS FOR A PARTICULAR PURPOSE, WHICH ARE HEREBY DISCLAIMED. IN NO EVENT SHALL NETAPP BE LIABLE FOR ANY DIRECT, INDIRECT, INCIDENTAL, SPECIAL, EXEMPLARY, OR CONSEQUENTIAL DAMAGES (INCLUDING, BUT NOT LIMITED TO, PROCUREMENT OF SUBSTITUTE GOODS OR SERVICES; LOSS OF USE, DATA, OR PROFITS; OR BUSINESS INTERRUPTION) HOWEVER CAUSED AND ON ANY THEORY OF LIABILITY, WHETHER IN CONTRACT, STRICT LIABILITY, OR TORT (INCLUDING NEGLIGENCE OR OTHERWISE) ARISING IN ANY WAY OUT OF THE USE OF THIS SOFTWARE, EVEN IF ADVISED OF THE POSSIBILITY OF SUCH DAMAGE.

NetApp reserves the right to change any products described herein at any time, and without notice. NetApp assumes no responsibility or liability arising from the use of products described herein, except as expressly agreed to in writing by NetApp. The use or purchase of this product does not convey a license under any patent rights, trademark rights, or any other intellectual property rights of NetApp.

The product described in this manual may be protected by one or more U.S. patents, foreign patents, or pending applications.

LIMITED RIGHTS LEGEND: Use, duplication, or disclosure by the government is subject to restrictions as set forth in subparagraph (b)(3) of the Rights in Technical Data -Noncommercial Items at DFARS 252.227-7013 (FEB 2014) and FAR 52.227-19 (DEC 2007).

Data contained herein pertains to a commercial product and/or commercial service (as defined in FAR 2.101) and is proprietary to NetApp, Inc. All NetApp technical data and computer software provided under this Agreement is commercial in nature and developed solely at private expense. The U.S. Government has a non-exclusive, non-transferrable, nonsublicensable, worldwide, limited irrevocable license to use the Data only in connection with and in support of the U.S. Government contract under which the Data was delivered. Except as provided herein, the Data may not be used, disclosed, reproduced, modified, performed, or displayed without the prior written approval of NetApp, Inc. United States Government license rights for the Department of Defense are limited to those rights identified in DFARS clause 252.227-7015(b) (FEB 2014).

Trademark information

NETAPP, the NETAPP logo, and the marks listed at <http://www.netapp.com/TM> are trademarks of NetApp, Inc. Other company and product names may be trademarks of their respective owners.